

FAN COILS & HYDRONIC TERMINALS



Controls for hydronic terminals

Airmust 3V A1 / 010 A1

Wi-Fi touch screen control / chronothermostat for wall installation



- 3.5" color LCD touch screen
- LCD resolution: 480x320 px
- Power supply 230V
- Maximum current (3V A1): 3A
- Thermostat function included
- Modbus
- 2.4G Wi-Fi connectivity
- APP available for Android and iOS: My House Pro
- 3-speed version (3V) or for 0-10 V motors (010)
- For 2-pipe and 4-pipe systems
- Window contact input
- Water probe inlet
- Automatic brightness
- Room temperature sensor
- Relative humidity sensor
- Operating mode management
- Mounting pitch with European standard
- Temperature and humidity measurement history
- Automatic changeover from cooling to heating mode
- Automatic management of daylight saving time / standard time changeover
- Multilingual
- Weekly schedule
- Weekly scheduling

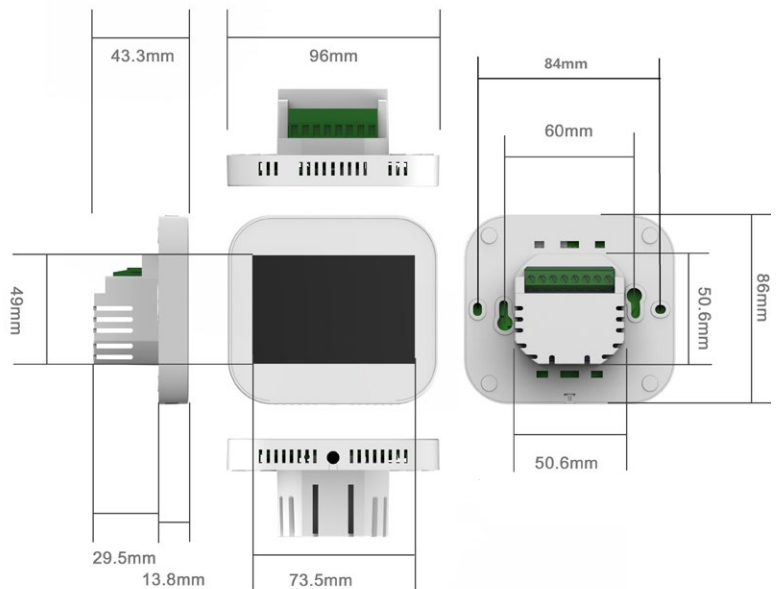

Air-Cooled Chiller

Three-speed wall-mounted thermostat

- Wall-mounted thermostat 230V
- Relay contacts 5A/230V
- 3-speed fan selector
- Off-On-Manual Selector
- Management of 2-pipe system with or without 230V on-off valves

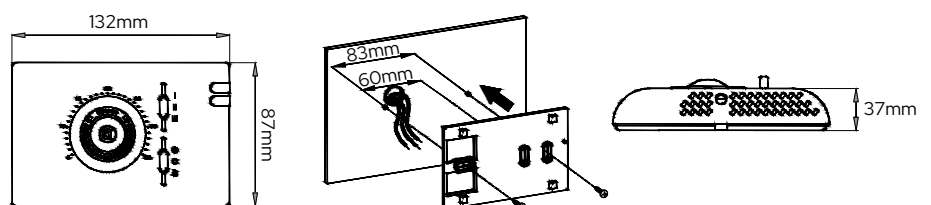

Airmust BMCP A1

Wi-Fi touch-screen controller for on-board installation on VSL fan coil units



- LCD display with five touch function keys
- Power supply 230V
- Maximum current: 5 A
- Thermostat function included
- Modbus
- 2.4G Wi-Fi connectivity
- App available on the stores for Android and iOS: SmartLife
- For 3-speed fan coil units
- For 2-pipe and 4-pipe systems
- Window contact input
- Water probe inlet
- Room temperature sensor
- Operating mode management
- Automatic changeover from cooling to heating mode
- Weekly scheduling (App only)

Airmust P

Wi-Fi touch-screen controller for wall-mounted installation



- LCD display with five touch function keys
- Power supply 230V
- Maximum current: 5 A
- Thermostat function included
- Modbus
- 2.4G Wi-Fi connectivity
- App available on the stores for **Android and iOS: SmartLife**
- For 3-speed fan coil units
- For 2-pipe and 4-pipe systems
- Window contact input
- Water probe inlet
- Room temperature sensor
- Operating mode management
- Automatic changeover from cooling to heating mode
- Weekly scheduling (App only)

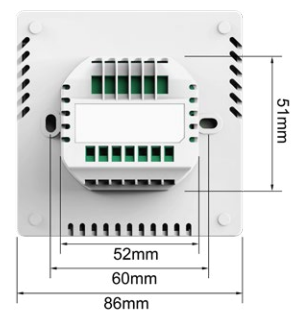





* Images related to Airmust BMCP A1 and Airmust P models

Price list

	Code	£
AIRMUST 3V A1	011993780000	229
AIRMUST 010 A1	011993790000	237
AIRMUST BMCP A1	012508260000	237
AIRMUST P	012508170000	237
Air-Cooled Chiller	0119950036020	102
SND-A3*	011993800000	9

* Compatible only with Airmust 3V A1 and 010A1 models

Compatibility table

					
	Air-Cooled Chiller	AIRMUST BMCP A1	AIRMUST P	AIRMUST 3V A1	AIRMUST O10 A1
GRIMPER MSL	X	X	■ (3)	X	X
GRIMPER VSL	X	■ (3)	■ (3)	X	X
GRIMPER BSL	X	X	■ (3)	X	X
VE: VMI, VMF, OMP, OMI	■	X	■ (1) (3)	■ (1)	X
VE: VII, VIF, OIP, OII	■	X	■ (1) (3)	■ (1)	X
VE: VMI, VMF, OMP, OMI Vers. MB	X	X	X	X	■ (1) (4)
VE: VII, VIF, OIP, OII Vers. MB	X	X	X	X	■ (1) (4)
HCN	■ (2)	X	■ (1) (3)	■ (1) (2)	X
HCN - Vers. MB	X	X	X	X	■ (1) (4)
HCNP	■ (2)	X	■ (1) (3)	■ (1) (2)	X
HCNP - Vers. MB	X	X	X	X	■ (1) (4)
HCNA	■ (2)	X	■ (1) (3)	■ (1) (2)	X
HCNA - Vers. MB	X	X	X	X	■ (1) (4)

(1) Not compatible with TMB – SND–A3 accessory required
 (2) Check the power consumption; if necessary, add the SDI accessory.
 (3) If necessary, add the STSL accessory for minimum winter temperature control.
 (4) SDI accessory not required

Compatible ■
 Not compatible X

Wiring diagrams

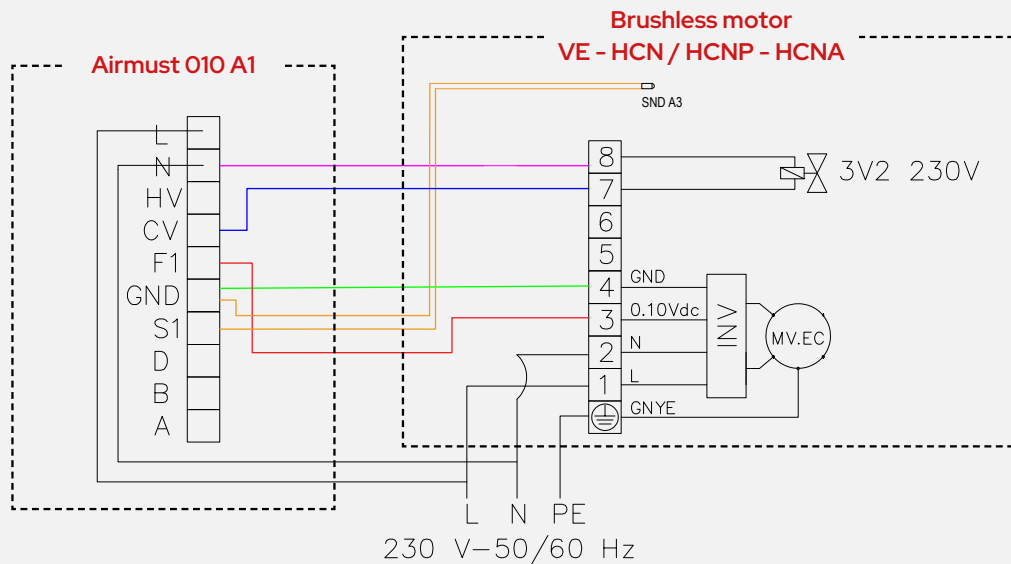
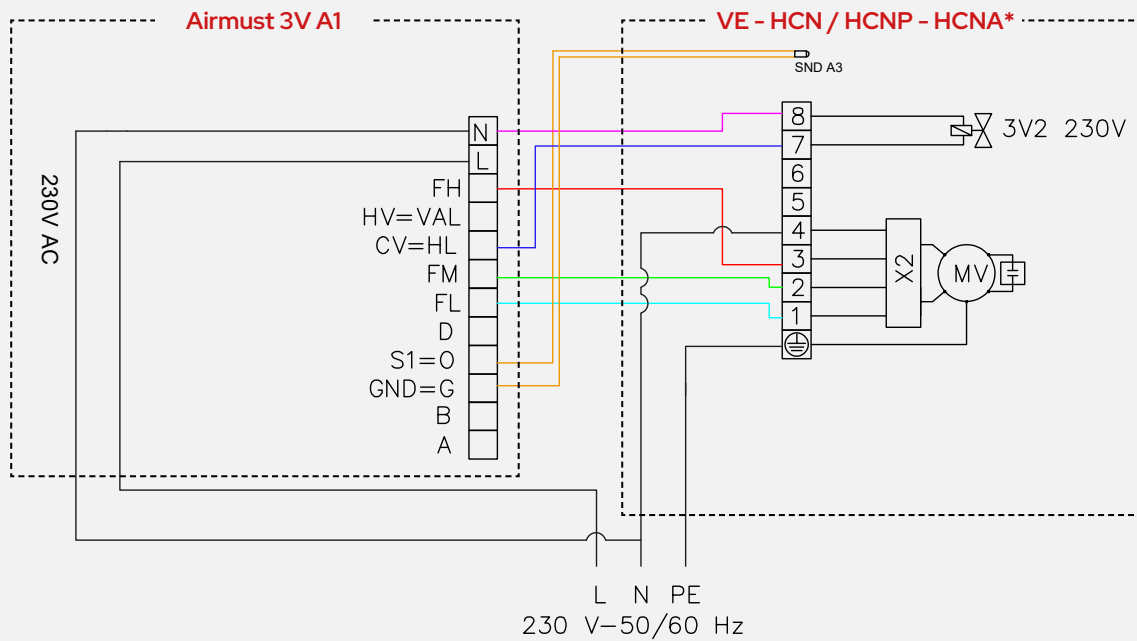
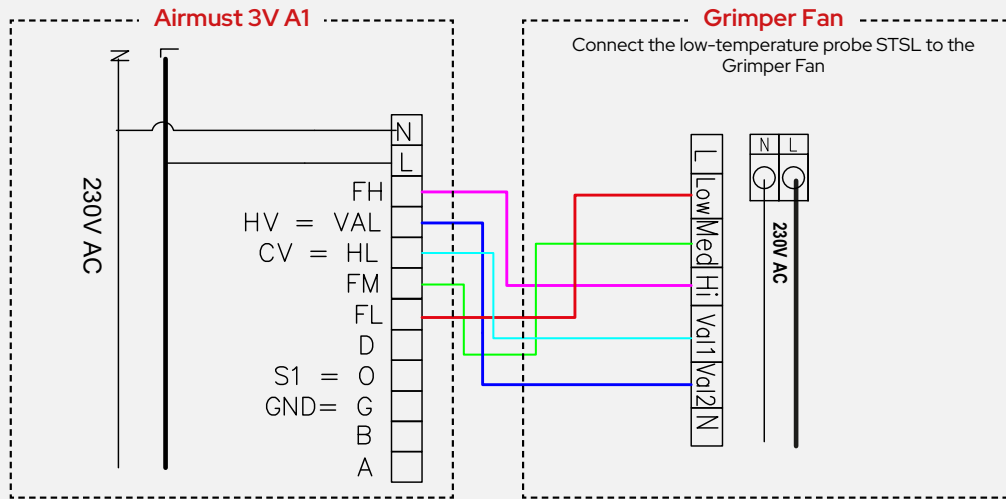

Wiring diagrams

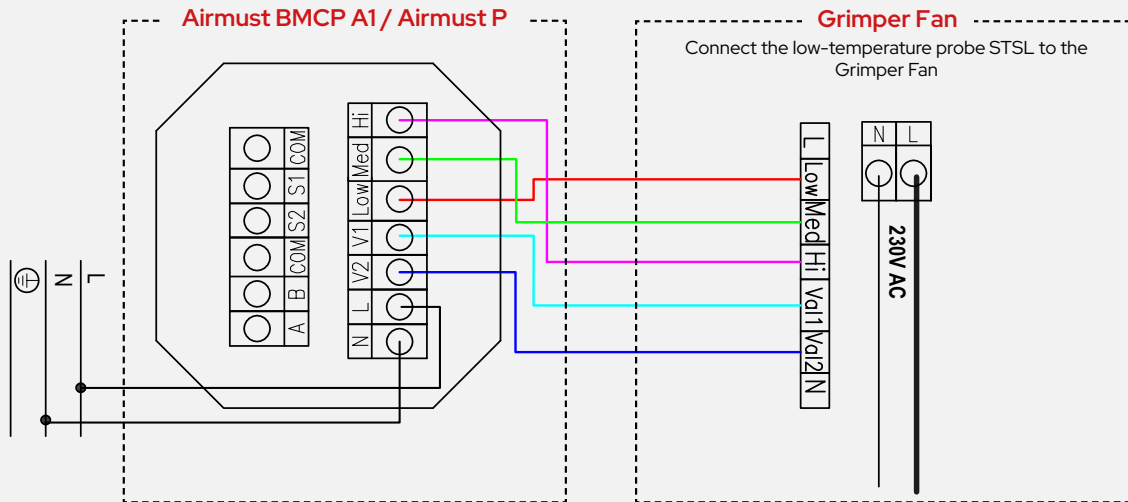

AIRMUST BMCP A1 / P: Parameter setting menu:
 No. 1 = 1.
 Leave all the others as default.
 Warning: do not connect the supplied probe

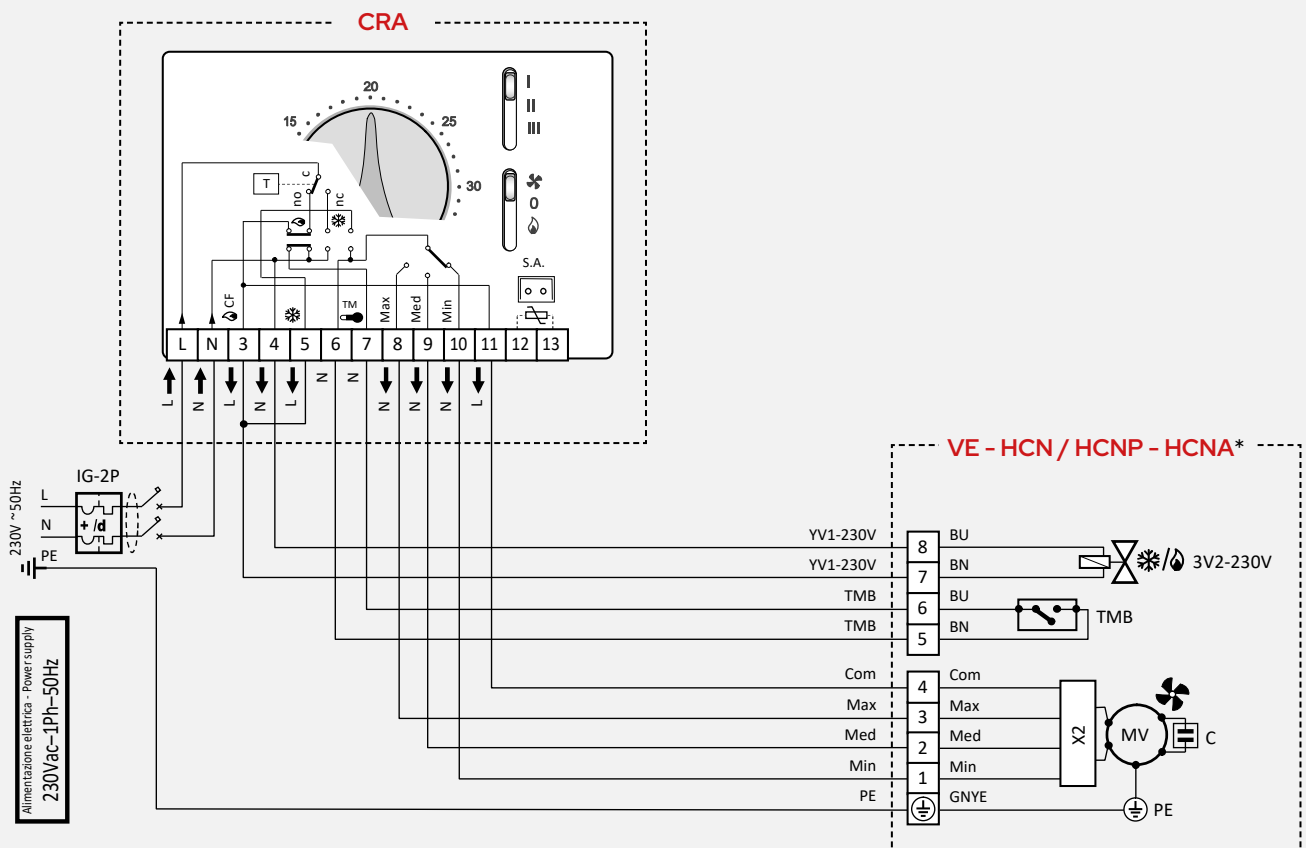

* Check the absorbed power; if necessary, add the SDI accessory.

Grimper Fan

Ultra-slim fan coil unit

0.9 kW–3.4 kW

The **12cm thick Grimper Fan range** is 10% thinner than its competitors in the slim segment.

The **pannello hardened glass front** is interchangeable on both sides to allow piping to be connected on the left/right side without additional operation.

Una feature that distinguishes the range is the **assenza front intake grilles**, thanks to the innovative ventilation system that improves battery performance when working at negative pressure.

Tutti the models are equipped with **ventilatori EC**, which improves quietness ensuring a noise level of less than **20 dB(A)**.



The absence of front grilles allows for versatile Grimper Fan installation even in the tightest spaces.

The MSL and VSL models are compatible with 2- and 4-pipe installations, while the BSL model is compatible with 2-pipe installations.

Completa the range i **filtri stainless steel pleated** with unlimited life, the **ventilatore aluminum tangential** and an included infrared **telecomando** (BSL, MSL models).

The entire Grimper Fan range offers simple and intuitive management thanks to the use of a touch screen control wire (accessory), and a convenient dedicated app. IT is possible to manage one or more connected units, both in residential and commercial settings.

La the range is made up of three models:

Grimper Fan MSL

High-wall installation

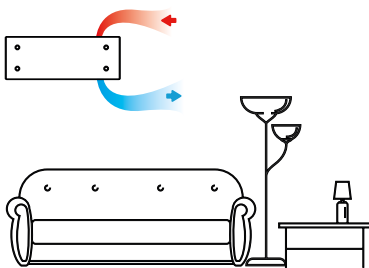

Grimper Fan VSL

Floor or ceiling installation

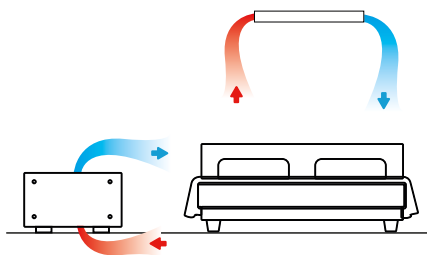

Grimper Fan BSL

Bathroom installation



Accessories

Supplied separately, common to the range

- **STSL**: Minimum water temperature sensor

Exclusive accessories for VSL model

- **2V2VSL**: 2-way straight valve kit with microswitch for VSL 09-27
- **2V2VSL34**: 2-way straight valve kit with microswitch for VSL 34
- **3V2VSL**: 3-way bypass valve kit with microswitch, 2-pipe, for VSL 09-27
- **3V2VSL34**: 3-way bypass valve kit with microswitch, 2-pipe, for VSL 34
- **3V4VSL**: 3-way bypass valve kit with micro switch, 4-pipe, for VSL
- **PEP09**: Rear aesthetic panel VSL 09
- **PEP18**: Rear aesthetic panel VSL 18
- **PEP27**: Rear aesthetic panel VSL 27
- **PEP34**: Rear aesthetic panel VSL 34
- **P-VSL**: Floor anchoring feet for VSL

- **VASL09:** Tray for horizontal installation VSL 09
- **VASL18:** Drip tray for horizontal installation VSL 18
- **VASL27:** Drip tray for horizontal installation VSL 27
- **VASL34:** Drip tray for horizontal installation VSL 34

Exclusive accessories for MSL model

- **2V2MSL:** 2-way straight valve kit with microswitch for MSL 12-17
- **2V2MSL25:** 2-way straight valve kit for MSL 25
- **3V2MSL:** 3-way bypass valve kit, 2-pipe, for MSL 12-17
- **3V2MSL25:** 3-way bypass valve kit, 2-pipe, for MSL 25

Exclusive accessories for BSL model

- **2V2BSL:** 2-way straight valve kit
- **3V2BSL:** 2-pipe 3-way bypass valve kit

			12	17	25
MSL	Total cooling capacity (max / med / min)	kW	1,20 / 0,81 / 0,70	1,70 / 1,20 / 0,90	2,45 / 1,60 / 1,18
	Heating capacity (max / med / min)	kW	1,68 / 1,14 / 0,96	2,45 / 1,90 / 1,53	3,30 / 2,20 / 1,70
	Air flow rate (min-max)	m³/h	155-315	240-450	310-540
	Minimum sound pressure level (SPL)	dB(A)	23,0	23,4	25,0
	Electric power (min-max)	W	4-11	5-14	8-17
	Power supply voltage	V-Hz	220-50	220-50	220-50
	Battery connections		1/2" GF	1/2" GF	1/2" GF
	Low-power DC motor		yes	yes	yes
	Aluminum tangential fan		yes	yes	yes
	Remote control		yes	yes	yes
	LCD display		yes	yes	yes
	Pleated stainless steel filter		yes	yes	yes
	Front panel in tempered glass crystal		yes	yes	yes
Unit frame in powder-coated steel		yes	yes	yes	

			09	18	27	34
VSL	Total cooling capacity (max / med / min)	kW	0,88 / 0,79 / 0,45	1,81 / 1,45 / 0,98	2,70 / 2,20 / 1,70	3,38 / 2,75 / 2,13
	Heating capacity (max / med / min)	kW	1,10 / 0,90 / 0,61	2,40 / 1,50 / 1,16	3,20 / 2,40 / 1,75	4,23 / 3,40 / 2,41
	Air flow rate (min-max)	m³/h	80-180	155-315	240-450	310-540
	Minimum sound pressure level (SPL)	dB(A)	20,5	21,6	23,5	21,7
	Electric power (min-max)	W	3-12	4-13	5-14	8-17
	Power supply voltage	V-Hz	220-50	220-50	220-50	220-50
	Battery connections		1/2" GF	1/2" GF	1/2" GF	3/4" GM
	Low-power DC motor		yes	yes	yes	yes
	Aluminum tangential fan		yes	yes	yes	yes
	Remote control		no	no	no	no
	LCD display		no	no	no	no
	Pleated stainless steel filter		yes	yes	yes	yes
	Front panel in tempered glass crystal		yes	yes	yes	yes
Unit frame in powder-coated steel		yes	yes	yes	yes	

			12
BSL	Total cooling capacity (max / med / min)	kW	1,20 / 0,90 / 0,60
	Thermal power (max / med / min)	kW	1,45 / 1,10 / 0,72
	Air flow rate (min-max)	m³/h	120-225
	Minimum sound pressure level (SPL)	dB(A)	19,1
	Electric power (min-max)	watt	4-11 (150*)
	Power supply voltage	V-Hz	220-50
	Battery connections		3/4" GM
	Low-power DC motor		yes
	Aluminum tangential fan		yes
	Remote control		yes
	LCD display		yes
	Pleated stainless steel filter		yes
Front panel in tempered glass crystal		yes	
Unit frame in powder-coated steel		yes	

Cooling test conditions: Room temperature: 27 °C - 47% RH, Water temperature (in/out): 7/12 °C
 Heating test conditions: ambient temperature: 20 °C, inlet water temperature: 50 °C, water flow rate as in cooling mode.

*Electric towel warmer heating element

Dimensional Drawings

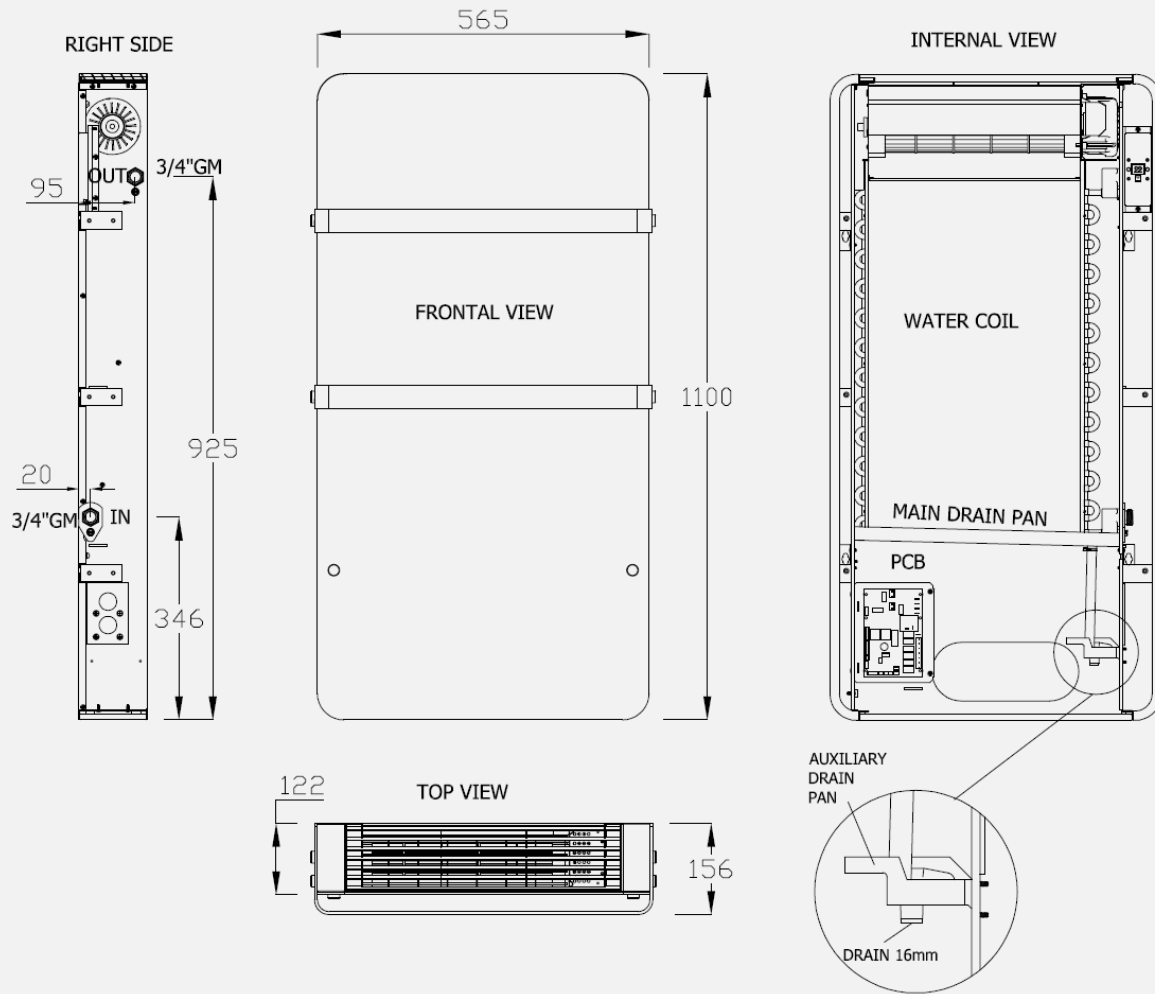

	12
Kg	18

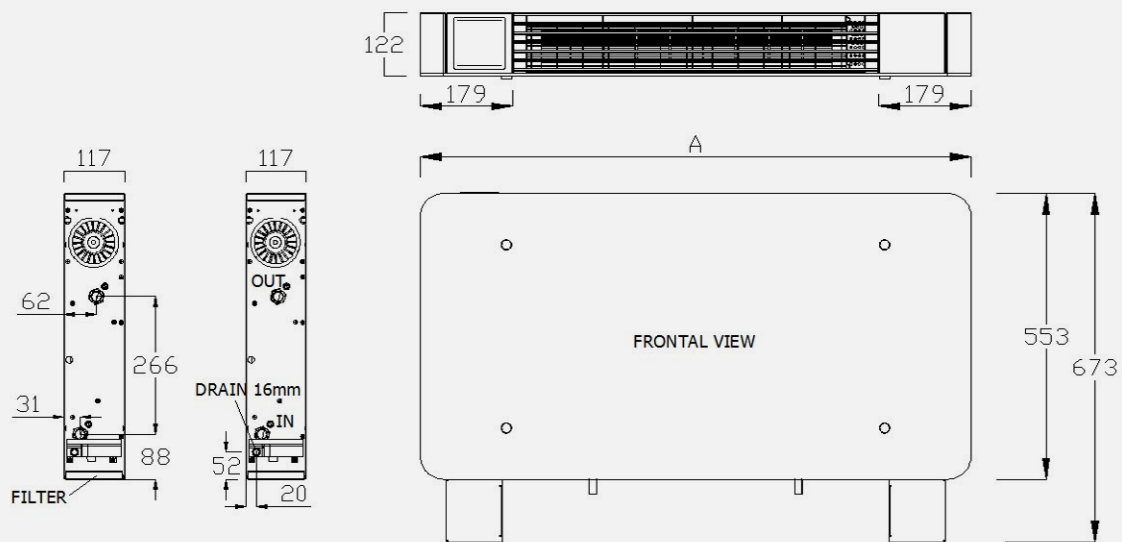

	09	18	27	34
A	681	873	1.065	1.257
Kg	18	21	24	27

Dimensions in mm

Dimensional Drawings

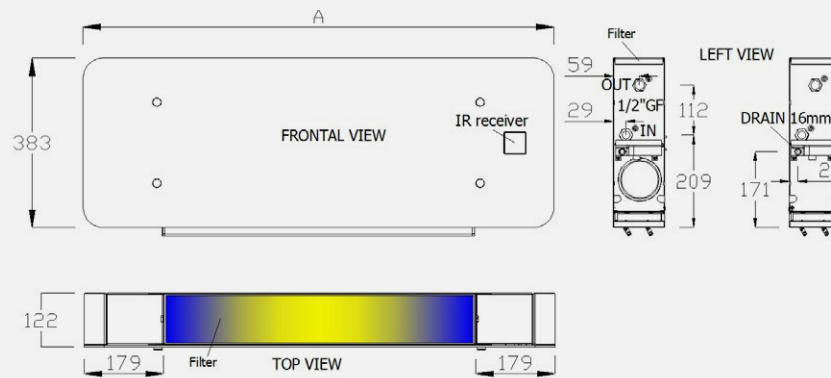

		12	17	25
A		873	1.065	1.257
Kg		16	17	20

Dimensions in mm

Price list

Grimper Fan VSL			09	18	27	34
VSL	Fan coil unit for low-wall and horizontal ceiling installation	code	011518040009	011518040018	011518040027	011518040034
		£	640	703	830	985
EXCLUSIVE ACCESSORIES FOR VSL MODEL						
		Compatibility	Code	£		
2V2VSL	2-way valve kit	VSL 9-27	012508090009	229		
3V2VSL	3-way bypass valve kit, 2-pipe system		012508140009	216		
3V4VSL	4-pipe bypass 3-way valve kit		012508080000	432		
2V2VSL34	2-way valve kit with microswitch	VSL 34	012508090034	229		
3V2VSL34	3-way bypass valve kit with microswitch, 2-pipe	VSL 34	012508140034	216		
P-VSL	Floor-mounting feet	VSL 9-34	012508100000	83		
PEP09	Rear aesthetic panel	VSL 09	012508130009	148		
PEP18	Rear aesthetic panel	VSL 18	012508130018	148		
PEP27	Rear aesthetic panel	VSL 27	012508130027	148		
PEP34	Rear aesthetic panel	VSL 34	012508130034	148		
VASL09	Drip tray for horizontal installation	VSL 09	012508120009	141		
VASL18	Drip tray for horizontal installation	VSL 18	012508120018	141		
VASL27	Drip tray for horizontal installation	VSL 27	012508120027	141		
VASL34	Drip tray for horizontal installation	VSL 34	012508120034	141		

Grimper Fan BSL			12	
BSL	Hydronic fan coil unit for the bathroom	code	011518050012	
		£	1.252	
EXCLUSIVE ACCESSORIES FOR BSL MODEL				
		Compatibility	Code	£
2V2BSL	2-way valve kit	BSL 12	012508090000	308
3V2BSL	3-way bypass valve kit, 2-pipe system	BSL 12	012508070012	291

Grimper Fan MSL			12	17	25
MSL	Hydronic fan coil unit for wall installation	code	011518030012	011518030017	011518030025
		£	941	1.023	1.151
EXCLUSIVE ACCESSORIES FOR MSL MODEL					
		Compatibility	Code	£	
2V2MSL	2-way valve kit	MSL 12-17	012508090018	222	
2V2MSL25	2-way valve kit	MSL 25	012508090027	222	
3V2MSL	3-way bypass valve kit, 2-pipe system	MSL 12-17	012508140018	240	
3V2MSL25	3-way bypass valve kit, 2-pipe system	MSL 25	012508140027	240	

ACCESSORIES SUPPLIED SEPARATELY COMMON TO THE RANGE			Code	£
STSL	Minimum water temperature probe		012508060000	34

For the wired controller price lists, refer to the pages at the beginning of the chapter.

VE: VMI, VMF, OMP, OMI

Fan coil unit with AC or brushless DC motor, complete with cabinet

1.4 kW–9.49 kW

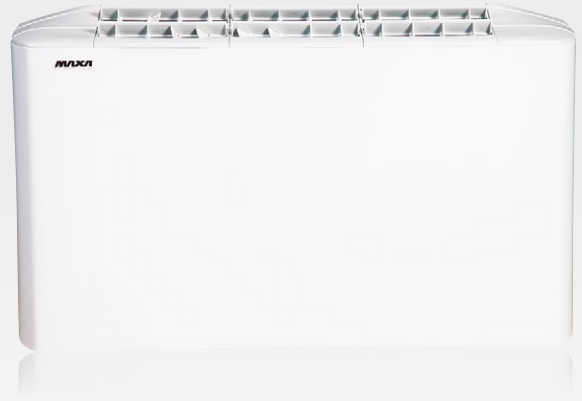

- Structure in galvanized sheet metal with pre-painted casing and ABS components, complete with thermal and acoustic insulation.
- Complete with regenerable filter.
- Standard gravity-drain condensate collection tray **(for horizontal units only)**.
- Six-speed centrifugal fans, three of which are connected in the standard configuration **(no MB)**.
- Three-row heat exchange coils with copper tubes and aluminum fins featuring a hydrophilic surface treatment for rapid condensate drainage.
- The installation of valve kits is recommended for every type of system.

S version

- Version with silenced motor, reduced condenser
- Thermal and acoustic insulation with reinforced anti-vibration system

MB version

- Brushless motor
- Ventilation modulation 0–100%

Version 4

- Version with second hydronic coil
- For 4-pipe systems
- Additional coil for heating only

Configurations



VMI: Vertical unit with bottom return air



OMP: Horizontal rear return air



VMF: Vertical unit with front air return



OMI: Horizontal unit, bottom return air

Versions

Standard

- **VE VMI:** Vertical, bottom return air
- **VE VMF:** Vertical front return
- **VE OMP:** Horizontal unit with rear return air
- **VE OMI:** Horizontal bottom return

Standard with Brushless Motor

- **VE VMI MB:** Vertical, bottom return with MB
- **VE VMF MB:** Vertical front return with MB
- **VE OMP MB:** Horizontal rear return with MB
- **VE OMI MB:** Horizontal unit with bottom return and MB

Muted

- **VE VMI S:** Vertical unit with bottom return, soundproofed
- **VE VMF S:** Vertical, front return, soundproofed
- **VE OMP S:** Horizontal with rear intake, soundproofed
- **VE OMI S:** Horizontal unit with bottom return, soundproofed

Silenced with brushless motor

- **VE VMI S MB:** Vertical unit with bottom return, soundproofed, with MB
- **VE VMF S MB:** Vertical unit, bottom return, soundproofed with MB
- **VE OMP S MB:** Horizontal unit with rear intake, soundproofed, with MB
- **VE OMI S MB:** Horizontal unit with bottom return, soundproofed, with MB

Available in a 4-pipe version. Refer to the price list for the codes.

Standard VE with left-hand connection. When ordering, it is possible to request connections on the right-hand side.

Accessories



P

Feet (supplied separately)



PCPB

Middle rear closing panel in pre-painted sheet metal



PCPF

Lower rear closing panel in pre-painted sheet metal



PCB

Lower closure panel without grille in pre-painted sheet metal



PMP1

Condensate pump (maximum water flow rate 8 l/h at 0 m.w.c., water flow rate 6.5 l/h at 1 m.w.c., water flow rate 4 l/h at 3 m.w.c., water flow rate 0 l/h at 6 m.w.c.) equipped with an alarm contact 8A@250V (suitable for all VERTICAL versions)



PMP2

Condensate pump (maximum water flow rate 8 l/h at 0 m.w.c., water flow rate 6.5 l/h at 1 m.w.c., water flow rate 4 l/h at 3 m.w.c., water flow rate 0 l/h at 6 m.w.c.) equipped with 8A@250V alarm contact (suitable for all HORIZONTAL versions).



VA

Auxiliary drip tray for vertical versions (included with horizontal versions)

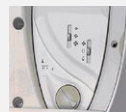

CVC

Onboard electronic control 230Vac with OFF/Summer/Winter + 3 fan speeds + thermostat with/without valves (including "Mammut" MOR terminal block)



CVA

Unit-mounted 3-speed control (including "Mammut" MOR terminal block).



CBB

On-unit controller for brushless motor, 2/4-pipe management with/without valves ("Mammut" MOR terminal block included). Compatible with TMB.



CVB

On-board 3-speed control with summer/winter selector and room thermostat ("Mammut" MOR terminal block included). Compatible with TMB.

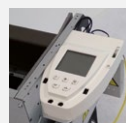

CVD1

On-board microprocessor control 230Vac + 2/4-pipe management with/without valves (including "Mammut" MOR terminal block). Compatible with TMB.



TMB

Low-limit bimetal thermostat: allows the automatic shutdown of ventilation if the temperature of the water entering the coil falls below 32°C in heating mode (winter). Compatible with CRA, CVC, CVA, CBB, CVB, CVD1.



SND-W4

Water temperature probe (NTC type, 4700 Ohm @ 25°C) with adjustable minimum setpoint, 1 m cable length. Alternative to TMB thermostat, compatible with CBB and CVD1.



SDI.4 X3A

4-output relay board. Suitable for controlling up to 4 three-speed motors. For AC motors only. Maximum rating: 4 x 3 A 230 Vac.



MOR

"Mammut"-type terminal block included when purchasing the fan coil unit complete with on-board controller. Must be ordered separately for wall-mounted controllers.



2V2

2-way valves for 2-pipe systems, with 230V actuator



3V2

3-way valves for 2-pipe system, with 230V actuator



2V4

2-way valves for 4-pipe system, with 230V actuator

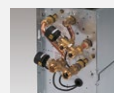

3V4

3-way valves for 4-pipe systems, with 230V actuator



TEL

System for remote-control management. Main board + air probe + water probe + IR receiver + remote control (management of 2/4-pipe systems, with/without valves). Fan: 7A-230Vac. Valves: 2A-230Vac. ("Mammut" MOR terminal block included).

VE			13	23	33	43	53	63	73	83	93	103	
3 ROWS **	Cooling capacity (1) *	max	W	1.500	2.000	2.530	3.020	3.570	4.250	5.520	6.420	7.530	9.020
		medium	W	1.317	1.755	2.264	2.702	3.521	3.991	5.211	6.062	7.107	8.515
		min	W	1.169	1.557	1.970	2.354	3.111	3.528	4.442	5.169	6.201	7.431
	Sensible cooling capacity		W	1.290	1.620	2.070	2.310	2.870	3.230	4.330	4.800	5.670	6.620
	Heating capacity (2) *	max	W	1.833	2.410	2.949	3.331	4.060	4.686	5.971	6.651	7.756	9.079
		medium	W	1.572	2.067	2.585	2.918	3.765	4.347	5.573	6.207	7.235	8.469
		min	W	1.369	1.799	2.198	2.481	3.252	3.757	4.614	5.136	6.151	7.199
	Heating capacity (3) *	max	W	3.678	4.837	5.916	6.682	8.144	9.401	11.978	13.339	15.556	18.209
		medium	W	3.154	4.146	5.185	5.852	7.551	8.718	11.176	12.447	14.508	16.983
		min	W	2.745	3.606	4.406	4.972	6.519	7.533	9.250	10.295	12.329	14.431
	Pressure drops in cooling *		kPa	14,5	18,1	20,5	23,0	25,1	26,8	27,2	30,0	31,9	32,4
	Pressure drops in heating (3) *		kPa	15,9	19,2	20,1	20,0	20,9	23,2	22,6	22,6	23,8	22,9
	Air flow rate *	max	m³/h	370	400	500	550	670	720	1.000	1.050	1.280	1.310
		medium	m³/h	285	308	400	440	590	634	890	935	1.139	1.166
		min	m³/h	226	244	305	336	462	497	650	683	870	891
	Water flow rate in cooling (*)		l/h	272	362	458	547	679	769	999	1.162	1.363	1.633
	Heating water flow rate (3) (*)		l/h	322	422	514	577	702	812	1.032	1.144	1.333	1.557
	Sound pressure (4)		dB(A)	24	25	30	31	26	27	34	35	39	40
31				31	38	38	33	34	41	41	46	46	
38				38	44	45	37	37	43	45	48	49	
Power supply		V~/Ph/Hz	230/1/50										
Hydraulic connections		"G	1/2"										
Condensate drain Ø		mm	20										
Electric motors		no.	1										
Power input *		W	55		85		75		145		175		
Fans		no.	1				2						
Thermal outputs in 4-pipe version	Cooling capacity (1) (*)		W	1.450	1.940	2.470	2.920	3.650	4.110	5.390	6.230	7.350	8.810
	Sensible capacity (1) (*)		W	1.240	1.570	2.020	2.220	2.780	3.110	4.210	4.640	5.520	6.440
	Thermal output (2) (*)		W	940	990	1.590	1.675	2.190	2.275	3.145	3.230	3.995	4.055
	Thermal output (3) (*)		W	1.880	1.980	3.180	3.350	4.380	4.550	6.290	6.460	7.990	8.110
	Pressure losses (3) (*)		kPa	7,3	8,0	11,7	12,9	21,3	22,9	41,1	43,3	37,7	38,8
BRUSHLESS **	Cooling capacity (1)		range W	1.810-880	2.320-1.130	2.830-1.400	3.220-1.600	4.630-2.130	5.070-2.330	6.010-3.060	6.820-3.470	7.440-3.780	8.790-4.460
	Thermal power (2)		range W	985-2.325	1.233-2.915	1.670-3.409	1.557-3.625	2.063-5.209	2.285-5.794	2.949-6.615	2.174-7.149	3.388-7.650	3.898-8.800
	Heating capacity (3)		range W	4.680-1.970	5.860-2.470	6.840-2.940	7.250-3.120	10.510-4.130	11.650-4.580	13.280-5.900	14.300-6.350	15.300-6.780	17.600-7.800
	Hot coil (2)		W	1.209-510	1.211-515	1.855-800	1.865-805	2.880-1.135	2.883-1.140	3.553-1.580	3.561-1.590	4.045-1.790	4.045-1.795
	Hot coil (3)		W	2.440-1.030	2.440-1.030	3.730-1.610	3.730-1.610	5.800-2.280	5.800-2.280	7.140-3.170	7.140-3.170	8.090-3.590	8.090-3.590
	Airflow		m³/h	537-127		625-153		1.021-215		1.184-306	1.184-306	1.255-323	
	Power input (5)		W	9		9		10		11	11	11	
	Sound pressure (5)		dB(A)	23		26		22		24	24	25	
	Power supply		V~/Ph/Hz	230/1/50									
	Signal		Vdc	0-10									
	Motors		no.	1									
Fans		no.	1				2						
S Versions *	Sound pressure (4)		dB(A)	10	10	14	14	12	12	17	17	15	15
				11	11	16	16	13	13	19	19	18	18
				16	16	22	22	18	18	25	25	24	24
S MB Versions *	Sound pressure (4)		dB(A)	10	10	10	10	11	12	11	12	10	10
				17	18	22	22	21	22	26	28	27	28
				30	31	34	36	30	31	35	36	39	40

Water connections on the left side

Note: Output and air flow rates are given at a static pressure of 0 Pa. For different available static pressures, refer to the air flow variation diagrams.

* For the remaining technical data, refer to the product manual.

** Data referring only to the 2-pipe version. For other versions, please refer to the product manual.

(1) Inlet air temperature: 27°C d.b. / 19.5°C w.b.

Water inlet/outlet temperature: 7°C / 12°C

(2) Inlet air temperature: 20°C d.b.

Water inlet/outlet temperature: 45°C / 40°C

(3) Inlet air temperature: 20°C d.b.

Water inlet/outlet temperature: 70°C / 60°C

(4) At a distance of 2 m and with a reverberation time of 0.5 s.

(5) With 3 VDC input signal

(*) Maximum speed

Dimensional Drawings

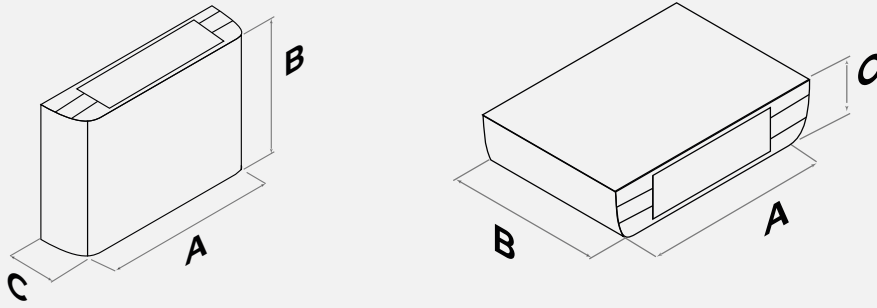

Dimensions - With casing										
VE	13	23	33	43	53	63	73	83	93	103
A*	670	670	870	870	1.070	1.070	1.270	1.270	1.470	1.470
B	520	520	520	520	520	520	520	520	520	520
C	220	220	220	220	220	220	220	220	220	220
Kg	13,5	14	16,4	17,2	22,5	23,5	26	27,5	30	31,5

Dimensions in mm

VE: VII, VIF, OIP, OII

Ductable/built-in fan coil unit with AC or DC brushless motor

1.4 kW–10.7 kW



- Galvanized sheet metal structure, complete with insulation.
- Complete with regenerable filter.
- Standard natural-drain condensate collection tray **(for horizontal units only)**.
- Six-speed centrifugal fans, three of which are connected in the standard configuration **(no MB)**.
- Three-row heat exchange coils with copper tubes and aluminum fins featuring a hydrophilic surface treatment for rapid condensate drainage.
- The installation of valve kits is recommended for every type of system.

S version

- Version with silenced motor, reduced capacitor.
- Thermal and acoustic insulation with reinforced anti-vibration system

MB version

- Brushless motor
- Ventilation modulation 0–100%

Version 4

- Version with second hydronic coil

- For 4-pipe systems
- Additional coil for heating only

P version

- Single-phase AC squirrel-cage asynchronous electric motor
- Thermal protection TH (Klixon)
- Run capacitor always engaged
- 4 poles, IP42, Class B, double insulation, 230Vac–1Ph–50/60Hz

Configurations



VII: Vertical built-in unit with bottom air return

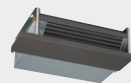

OIP: Horizontal recessed unit with rear return air intake



VIF: Vertical built-in unit with front return air intake



OII: Horizontal built-in unit with bottom return air intake

Versions

Standard

- **VE VII:** Vertical built-in unit with bottom air return
- **VE VIF:** Vertical built-in unit with front return air intake
- **VE OIP:** Horizontal concealed units with rear return air intake
- **VE OII:** Horizontal concealed units with bottom return air intake

Enhanced

- **VE VII P:** Enhanced recessed vertical unit with bottom return air
- **VE VIF P:** Enhanced vertical recessed unit with front return air
- **VE OIP P:** Horizontal recessed units with rear return, enhanced
- **VE OII P:** Horizontal ducted units, enhanced lower return

Enhanced with Brushless Motor

- **VE VII P MB:** Vertical built-in unit with enhanced bottom return and MB
- **VE VIF P MB:** Enhanced built-in vertical unit with front return, with MB
- **VE OIP P MB:** Recessed horizontal rear return, enhanced with MB
- **VE OII P MB:** Horizontal ducted units with bottom return, enhanced with MB

Standard with Brushless Motor

- **VE VII MB:** Recessed vertical unit with bottom return, with MB
- **VE VIF MB:** Vertical concealed front-return unit with MB
- **VE OIP MB:** Horizontal concealed units with rear return, with MB
- **VE OII MB:** Horizontal ductable units with bottom return air and MB

Muted

- **VE VII S:** Vertical built-in unit, bottom return, soundproofed
- **VE VIF S:** Vertical built-in front return, soundproofed
- **VE OIP S:** Horizontal recessed rear-return silenced units
- **VE OII S:** Horizontal ducted concealed units with bottom air return, soundproofed

Silenced with brushless motor

- **VE VII S MB:** Vertical built-in unit with lower return, soundproofed, with MB
- **VE VIF S MB:** Vertical built-in front-return silenced unit with MB
- **VE OIP S MB:** Horizontal built-in rear return silenced unit with MB
- **VE OII S MB:** Horizontal concealed unit, bottom return, soundproofed, with MB

Available in a 4-pipe version. Refer to the price list for the codes.

Standard VE with left-hand connection. When ordering, it is possible to request connections on the right-hand side.

Accessories

	PA	Suction plenum with circular connections	Size	13/23	33/43	53/63	73/83	93/103
			No. of connections with concentric collars Ø 200/180/160 mm	1	2	2	3	4
	PM	Supply plenum with circular connections						
	P1	Aesthetic panel in pre-painted sheet metal complete with intake and supply grille.		P2	Aesthetic panel in pre-painted sheet metal complete with supply and return air grille, equipped with inspection doors for access to controls.			
	PMI	90° supply air plenum		FTI	Preparation frame in galvanized sheet metal. Suitable for creating the installation recess.			
	PMP1	Condensate pump (maximum water flow rate 8 l/h at 0 m.w.c., water flow rate 6.5 l/h at 1 m.w.c., water flow rate 4 l/h at 3 m.w.c., water flow rate 0 l/h at 6 m.w.c.) equipped with an alarm contact 8A@250V (suitable for all VERTICAL versions)		PMP2	Condensate pump (maximum water flow rate 8 l/h at 0 m.w.c., water flow rate 6.5 l/h at 1 m.w.c., water flow rate 4 l/h at 3 m.w.c., water flow rate 0 l/h at 6 m.w.c.) equipped with 8A@250V alarm contact (suitable for all HORIZONTAL versions).			
	TMB	Low-limit bimetal thermostat: allows the automatic shutdown of ventilation if the temperature of the water entering the coil falls below 32°C in heating mode (winter). Compatible with CRA, CVC, CVA, CBB, CVB, CVD1.		SND-W4	Water temperature probe (NTC type, 4700 Ohm @ 25°C) with adjustable minimum setpoint, 1 m cable length. Alternative to TMB thermostat, compatible with CBB and CVD1.			
	SDI.4 X3A	4-output relay board. Suitable for controlling up to 4 three-speed motors. For AC motors only. Maximum rating: 4 x 3 A 230 Vac.		MOR	“Mammut”-type terminal block included when purchasing the fan coil unit complete with on-board controller. Must be ordered separately for wall-mounted controllers.			
	2V2	2-way valves for 2-pipe systems, with 230V actuator		3V2	3-way valves for 2-pipe system, with 230V actuator			
	2V4	2-way valves for 4-pipe system, with 230V actuator		3V4	3-way valves for 4-pipe systems, with 230V actuator			
	TEL	System for remote-control management. Main board + air probe + water probe + IR receiver + remote control (management of 2/4-pipe systems, with/without valves). Fan: 7A-230Vac. Valves: 2A-230Vac. (“Mammut” MOR terminal block included).						

For vertical VII/VIF and horizontal OIP/OII versions in sizes 13, 23, 33 and 43, the EC motor electronic board is mounted externally on the short side of the unit.

VE: VII, VIF, OIP, OII				13	23	33	43	53	63	73	83	93	103	
Thermal outputs in 2-pipe version	Cooling capacity (1) *	max	W	1.579	2.105	2.663	3.179	3.947	4.474	5.811	6.758	7.926	9.495	
		medium	W	1.317	1.755	2.264	2.702	3.521	3.991	5.211	6.062	7.107	8.515	
		min	W	1.169	1.557	1.970	2.354	3.111	3.528	4.442	5.169	6.201	7.431	
	Sensible cooling capacity			W	1.290	1.620	2.070	2.310	2.870	3.230	4.330	4.800	5.670	6.620
	Heating capacity (2) *	max	W	1.870	2.455	2.990	3.355	4.080	4.720	6.000	6.650	7.750	9.050	
		medium	W	1.572	2.067	2.585	2.918	3.765	4.347	5.573	6.207	7.235	8.469	
		min	W	1.369	1.799	2.198	2.481	3.252	3.757	4.614	5.136	6.151	7.199	
	Heating capacity (3) *	max	W	3.740	4.910	5.980	6.710	8.160	9.440	12.000	13.300	15.500	18.100	
		medium	W	3.154	4.146	5.185	5.852	7.551	8.718	11.176	12.447	14.508	16.983	
		min	W	2.745	3.606	4.406	4.972	6.519	7.533	9.250	10.195	12.329	14.431	
	Pressure drops in cooling *			kPa	14,5	18,1	20,5	23,0	25,1	26,8	27,2	30,0	31,9	32,4
	Pressure drops in heating (3) *			kPa	15,9	19,2	20,1	20,0	20,9	23,2	22,6	22,6	23,8	22,9
	Chilled water flow rate *			l/h	272	362	458	547	679	769	999	1.162	1.363	1.633
	Heating water flow rate (3) *			l/h	322	422	514	577	702	812	1.032	1.144	1.333	1.557
	Air flow rate *	max	m³/h	370	400	500	550	670	720	1.000	1.050	1.280	1.310	
		medium	m³/h	285	308	400	440	590	634	890	935	1.139	1.166	
		min	m³/h	226	244	305	336	462	497	650	683	870	891	
	Sound pressure (4)	dB(A)			24	25	30	31	26	27	34	35	39	40
					31	31	38	38	33	34	41	41	46	46
					38	38	44	45	37	37	43	45	48	49
Power supply		V~/Ph/Hz	230/1/50											
Hydraulic connections		"G	1/2" F											
Condensate drain Ø		mm	20											
Electric motors		no.	1											
Power input *		W	55		85		75		145		175			
Fans		no.	1				2							
Maximum available static pressure (7)		Pa	60											
Thermal outputs in 4-pipe version	Cooling capacity (1) *		W	1.450	1.940	2.470	2.920	3.650	4.110	5.390	6.230	7.350	8.810	
	Sensible capacity (1) *		W	1.240	1.570	2.020	2.220	2.780	3.110	4.210	4.640	5.520	6.440	
	Thermal output (2) *		W	940	990	1.590	1.675	2.190	2.275	3.145	3.230	3.995	4.055	
	Thermal power (3) *		W	1.880	1.980	3.180	3.350	4.380	4.550	6.290	6.460	7.990	8.110	
	Pressure drops (3) *		kPa	7,3	8,0	11,7	12,9	21,3	22,9	41,1	43,3	37,7	38,8	
Thermal outputs in brushless version **	Cooling capacity (1)		range W	1.810	2.320	2.830	3.220	4.630	5.070	6.010	6.820	7.440	8.790	
	Thermal power (2)		range W	985	1.233	1.670	1.557	2.063	2.285	2.949	2.174	3.388	3.898	
	Heating capacity (3)		range W	4.680	5.860	6.840	7.250	10.510	11.650	13.280	14.300	15.300	17.600	
	Airflow		m³/h	537	536	625	627	1.018	1.022	1.180	1.187	1.255	1.255	
	Power input (5)		W	9	9	9	9	10	10	11	11	11	11	
	Sound pressure (5)		dB(A)	23	23	26	26	22	22	24	24	25	25	
	Power supply		V~/Ph/Hz	230/1/50										
	Signal		Vdc	0-10										
	Motors		no.	1										
	Fans		no.	1				2						
Maximum available static pressure (7)		Pa	70											
Thermal outputs in 4-pipe brushless version	Hot coil (2)		W	895	938	1.479	1.556	2.087	2.163	2.959	3.057	3.633	3.687	
	Hot coil (3)(6)		W	1.800	1.880	2.960	3.120	4.180	4.330	5.920	6.120	7.270	7.370	

Water connections on the left side

* For the remaining technical data, refer to the product manual.

** Data referring only to the 2-pipe version. For other versions, please refer to the product manual.

(1) Inlet air temperature: 27°C d.b. / 19.5°C w.b.

Water inlet/outlet temperature: 7°C / 12°C

(2) Inlet air temperature: 20°C d.b.

Water inlet/outlet temperature: 45°C / 40°C

(3) Inlet air temperature: 20°C d.b.

Water inlet/outlet temperature: 70°C / 60°C

(4) At a distance of 2 m and with a reverberation time of 0.5 s.

(5) Rated nameplate electrical power input

(6) Version 4

(7) For performance data, refer to the product technical manual.

Performances and airflows are specified at a pressure head of 0 Pa.
For different available pressure values, refer to the product technical brochure by scanning the QR Code.
(7) For performance data, refer to the product technical manual.



FAN COIL UNITS: VII, VIF, OIP, OII P version				13	23	33	43	53	63	73	83	93	103	
Heating capacities in enhanced 2-pipe version	Cooling capacity (1) *	max	W	1.683	2.296	2.899	3.255	4.163	4.701	6.164	7.150	8.568	10.337	
		medium	W	1.577	2.141	2.812	3.242	3.851	4.357	5.848	6.800	8.082	9.770	
		min	W	1.387	1.879	2.650	3.062	3.345	3.807	5.075	5.910	7.060	8.499	
	Sensible cooling capacity			W	1.380	1.790	2.270	2.450	3.050	3.420	4.630	5.120	6.200	7.300
	Heating capacity (2) *	max	W	2.000	2.692	3.260	3.553	4.317	4.976	6.389	7.061	8.415	9.895	
		medium	W	1.852	2.477	3.157	3.410	3.936	4.545	6.000	6.651	7.849	9.253	
		min	W	1.592	2.124	2.942	3.187	3.335	3.878	5.078	5.637	6.693	7.851	
	Heating capacity (3) *	max	W	4.000	5.380	6.510	7.100	8.630	9.950	12.760	14.120	16.830	19.790	
		medium	W	3.704	4.954	6.313	6.821	7.872	9.090	12.000	13.300	15.700	18.506	
		min	W	3.184	4.249	5.885	6.374	6.671	7.757	10.156	11.276	13.388	15.704	
	Pressure drops in cooling *			kPa	14.7	19.4	21.6	23.0	25.1	26.5	27.5	30.3	33.7	34.6
	Pressure drops in heating (3) *			kPa	18.1	23.0	23.8	22.3	23.4	25.8	25.6	25.6	28.0	27.4
	Chilled water flow rate *			l/h	273	375	471	547	679	767	1.006	1.168	1.400	1.689
	Heating water flow rate (3) *			l/h	344	463	560	611	742	856	1.098	1.214	1.447	1.702
	Air flow rate *	max	m³/h	410	460	570	600	730	780	1.100	1.150	1.450	1.500	
		medium	m³/h	360	400	540	560	625	670	990	1.040	1.290	1.340	
min		m³/h	280	310	480	500	475	515	750	790	990	1.020		
Sound pressure (4)			dB(A)	29	30	41	42	25	27	37	38	43	44	
				36	38	44	45	32	34	43	44	44	49	
				39	42	45	47	37	39	47	48	51	52	
Power supply		V~/Ph/Hz	230/1/50											
Hydraulic connections		"G	1/2" F											
Condensate drain Ø		mm	20											
Electric motors		no.	1											
Power input *		W	55			125		115		195		230		
Fans		no.	1				2							
Maximum available static pressure (7)		Pa	87	87	105	105	100	100	103	103	115	115		
Heating capacities in enhanced 4-pipe version	Cooling capacity (1) *		W	1.550	2.120	2.680	3.150	3.890	4.330	5.710	6.640	7.970	9.620	
	Sensible capacity (1) *		W	1.330	1.740	2.220	2.430	2.990	3.300	4.500	4.990	6.050	7.130	
	Thermal output (2) *		W	1.009	1.090	1.739	1.820	2.345	2.405	3.347	3.460	4.350	4.450	
	Thermal power (3) *		W	2.010	2.180	3.470	3.640	4.690	4.810	6.690	6.910	8.700	8.900	
	Pressure drops (3) *		kPa	8,3	9,7	13,9	15,3	24,4	25,6	46,5	49,6	44,7	46,8	
Thermal outputs in enhanced brushless version **	Cooling capacity (1)		range	W	1.670	2.220	2.830	3.280	4.310	4.880	6.010	6.970	8.470	10.210
	Thermal power (2)		range	W	2.096	2.749	3.372	3.679	4.736	5.468	6.579	7.262	8.793	10.325
	Heating capacity (3)		range	W	4.190	5.490	6.740	7.330	9.470	10.930	13.150	14.520	17.580	20.640
	Airflow		m³/h	440	475	600	630	840	900	1.150	1.200	1.550	1.600	
	Power input (5)		W	55	55	65	65	85	85	90	90	180	180	
	Sound pressure (5)		dB(A)	13	13	16	16	16	16	17	17	20	20	
				29	30	33	35	29	31	36	37	43	44	
				40	43	47	48	42	44	48	49	52	53	
	Power supply		V~/Ph/Hz	230/1/50										
	Signal		Vdc	0-10										
Motors		no.	1											
Fans		no.	1				2							
Maximum available static pressure (7)		Pa	103	103	111	112	120	120	137	138	174	175		
Heating capacities in enhanced 4-pipe brushless version	Hot coil (2)		W	1.052	1.107	1.822	1.861	2.573	2.635	3.440	3.542	4.552	4.689	
	Hot coil (3)(6)		W	2.100	2.210	3.640	3.720	5.070	5.270	6.880	7.080	9.100	9.370	

Water connections on the left side

* For the remaining technical data, refer to the product manual.

** Data refers only to the 2-pipe unit in the silenced version. For other versions, refer to the product manual.

(1) Inlet air temperature: 27°C d.b. / 19.5°C w.b.

Water inlet/outlet temperature: 7°C / 12°C

(2) Inlet air temperature: 20°C d.b.

Water inlet/outlet temperature: 45°C / 40°C

(3) Inlet air temperature: 20°C d.b.

Water inlet/outlet temperature: 70°C / 60°C

(4) At a distance of 2 m and with a reverberation time of 0.5 s.

(5) Rated nameplate electrical power input

(6) Version 4

(7) For performance data, refer to the product technical manual.

**Performances and airflows are specified at a pressure head of 0 Pa.
For different available pressure values, refer to the product technical brochure by scanning the QR Code.
(7) For performance data, refer to the product technical manual.**



VE: VII, VIF, OIP, OII S version				13	23	33	43	53	63	73	83	93	103		
Thermal outputs in 2-pipe silenced version	Cooling capacity (1) *	max	W	1.030	1.390	1.810	2.160	2.690	3.050	3.900	4.590	4.860	5.960		
		medium	W	932	1.276	1.653	1.965	2.514	2.880	3.641	4.277	4.453	5.460		
		min	W	831	1.154	1.532	1.834	2.386	2.747	3.427	4.042	4.156	5.118		
	Sensible cooling capacity			W	840	1.060	1.410	1.570	1.950	2.200	2.900	3.260	3.420	4.100	
	Heating capacity (2) *	max	W	1.247	1.656	2.088	2.348	2.856	3.309	4.143	4.649	4.858	5.818		
		medium	W	1.050	1.419	1.770	1.977	2.490	2.917	3.597	4.029	4.129	4.942		
		min	W	917	1.262	1.620	1.823	2.342	2.759	3.350	3.770	3.808	4.582		
	Heating capacity (3) *	max	W	2.500	3.320	4.180	4.700	5.720	6.620	8.290	9.300	9.720	11.640		
		medium	W	2.099	2.839	3.541	3.954	4.981	5.834	7.195	8.059	8.259	9.885		
		min	W	1.834	2.524	3.240	3.647	4.685	5.519	6.701	7.542	7.617	9.164		
	Pressure drops in cooling *			kPa	6,2	7,9	9,4	10,6	11,6	12,4	12,2	13,8	12,0	12,7	
	Pressure drops in heating (3) *			kPa	7,1	8,7	9,8	9,8	10,3	11,4	10,8	11,1	9,4	9,5	
	Chilled water flow rate *			l/h	177	239	311	372	463	525	671	789	836	1.025	
	Heating water flow rate (3) *			l/h	215	286	359	404	492	569	713	800	836	1.001	
	Air flow rate *	max	m³/h	200	220	290	320	390	420	570	610	630	670		
		medium	m³/h	150	170	220	240	310	340	450	480	480	510		
min		m³/h	120	140	190	210	280	310	400	430	420	450			
Sound pressure (4)			dB(A)	10	10	14	14	12	12	17	17	15	15		
				11	11	16	16	13	13	19	19	18	18		
				16	16	22	22	18	18	25	25	24	24		
Power supply		V~/Ph/Hz	230/1/50												
Hydraulic connections		"G	1/2" F												
Condensate drain Ø		mm	20	20	20	20	20	20	20	20	20	20	20		
Electric motors		no.	1	1	1	1	1	1	1	1	1	1			
Power input *		W	55			80			145			180			
Fans		no.	1			2									
Maximum available static pressure (7)		Pa	60			63			75			78			
Heating/cooling capacities in 4-pipe silenced version	Cooling capacity (1) *		W	1.000	1.350	1.760	2.080	2.600	2.960	3.820	4.450	4.760	5.790		
	Sensible capacity (1) *		W	810	1.030	1.380	1.500	1.880	2.130	2.830	3.150	3.350	3.970		
	Thermal output (2) *		W	628	670	1.115	1.166	1.526	1.604	2.179	2.256	2.517	2.595		
	Thermal power (3) *		W	1.260	1.340	2.230	2.340	3.060	3.210	4.360	4.520	5.040	5.190		
	Pressure drops (3) *		kPa	3,3	3,7	5,7	6,3	10,4	11,4	19,7	21,1	15,0	15,9		
Heating capacities in silenced brushless version **	Cooling capacity (1)		range	W	1.430	1.910	2.380	2.820	3.600	4.070	5.230	6.070	6.860	8.240	
	Thermal power (2)		range	W	1.769	2.332	2.798	3.109	3.897	4.501	5.659	6.269	7.014	8.210	
	Heating capacity (3)		range	W	3.540	4.670	5.580	6.220	7.800	9.010	11.320	12.540	14.030	16.430	
	Airflow		m³/h	340	370	450	490	625	670	915	960	1.100	1.130		
	Input power (5)		W	55	55	65	65	85	85	90	90	90	90		
	Sound pressure (5)		dB(A)	10	10	10	10	11	12	11	12	10	10		
				17	18	22	22	21	22	26	28	27	28		
				30	31	34	36	30	31	35	36	39	40		
	Power supply		V~/Ph/Hz	230/1/50											
	Signal		Vdc	0-10											
Motors		no.	1												
Fans		no.	1			2									
Maximum available static pressure (7)		Pa	72	72	79	80	85	85	86	86	73	83			
Thermal capacities in soundproofed brushless 4-pipe version	Hot coil (2)		W	895	938	1.479	1.556	2.087	2.163	2.959	3.057	3.633	3.687		
	Hot coil (3)(6)		W	1.800	1.880	2.960	3.120	4.180	4.330	5.920	6.120	7.270	7.370		

Water connections on the left side

* For the remaining technical data, refer to the product manual.

** Data refers only to the 2-pipe unit in the silenced version. For other versions, refer to the product manual.

(1) Inlet air temperature: 27°C d.b. / 19.5°C w.b.

Water inlet/outlet temperature: 7°C / 12°C

(2) Inlet air temperature: 20°C d.b.

Water inlet/outlet temperature: 45°C / 40°C

(3) Inlet air temperature: 20°C d.b.

Water inlet/outlet temperature: 70°C / 60°C

(4) At a distance of 2 m and with a reverberation time of 0.5 s.

(5) Rated nameplate electrical power input

(6) Version 4

(7) For performance data, refer to the product technical manual.

Performances and airflows are specified at a pressure head of 0 Pa.
For different available pressure values, refer to the product technical brochure by scanning the QR Code.
(7) For performance data, refer to the product technical manual.



Dimensional Drawings

VII, VIF

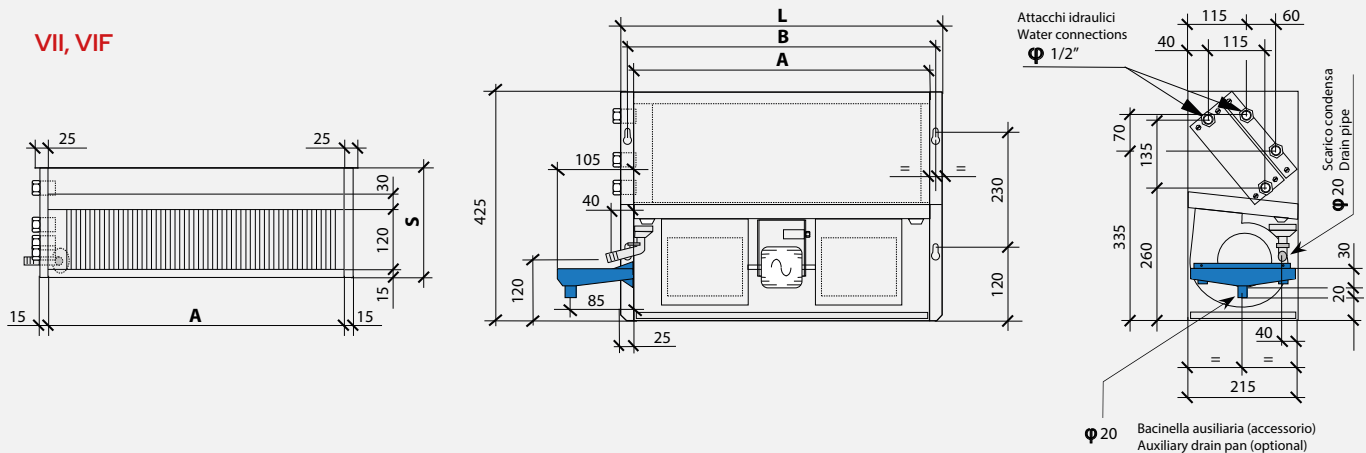

Dimensions of vertical versions

VE		13	23	33	43	53	63	73	83	93	103
A	mm	400	400	600	600	800	800	1.000	1.000	1.200	1.200
B	mm	425	425	625	625	825	825	1.025	1.025	1.225	1.225
L	mm	450	450	650	650	850	850	1.050	1.050	1.250	1.250

OII, OIP

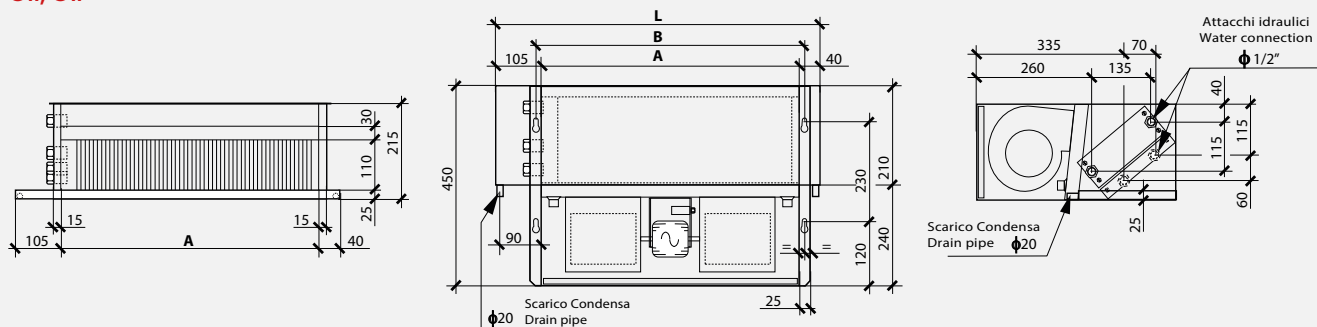

Dimensions of horizontal versions

VE		13	23	33	43	53	63	73	83	93	103
A	mm	400	400	600	600	800	800	1.000	1.000	1.200	1.200
B	mm	425	425	625	625	825	825	1.025	1.025	1.225	1.225
L	mm	545	545	745	745	945	945	1.145	1.145	1.345	1.345

FTI

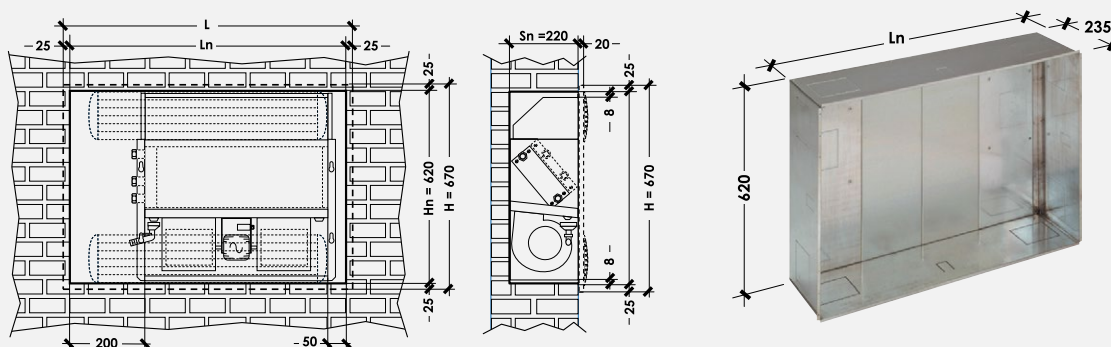

Line	mm	13/23	33/43	53/63	73/83	93/103
L	mm	700	900	1.100	1.300	1.500

Price list

VMi: Vertical unit with cabinet and bottom return air intake

	VE VMI - Vertical with bottom return air		VE VMI S - Vertical unit with bottom return, soundproofed		VE VMI 4 - Vertical, bottom return, 4-pipe		VE VMI 4/S - Vertical, bottom silenced return, 4-pipe	
Size	Code	£	Code	£	Code	£	Code	£
13	011413000130300	438	0114130020130300	522	0114132200130300	602	0114132220130300	645
23	011413000230300	462	0114130020230300	549	0114132200230300	629	0114132220230300	672
33	011413000330300	482	0114130020330300	579	0114132200330300	668	0114132220330300	720
43	011413000430300	533	0114130020430300	636	0114132200430300	724	0114132220430300	776
53	011413000530300	580	0114130020530300	696	0114132200530300	799	0114132220530300	860
63	011413000630300	648	0114130020630300	771	0114132200630300	874	0114132220630300	934
73	011413000730300	733	0114130020730300	874	0114132200730300	987	0114132220730300	1.057
83	011413000830300	797	0114130020830300	944	0114132200830300	1.057	0114132220830300	1.127
93	011413000930300	861	0114130020930300	1.020	0114132200930300	1.164	0114132220930300	1.243
103	011413001030300	924	0114130021030300	1.087	0114132201030300	1.231	0114132221030300	1.310

	VE VMI MB - Vertical, bottom return, brushless		VE VMI MB S - Vertical, bottom return, silenced, brushless		VE VMI MB 4 - Vertical, bottom air return, 4-pipe brushless		VE VMI MB 4/S - Vertical low-noise bottom return 4-pipe brushless	
Size	Code	£	Code	£	Code	£	Code	£
13	0114131100130300	623	0114131120130300	704	0114133000130300	788	0114133020130300	828
23	0114131100230300	641	0114131120230300	732	0114133000230300	816	0114133020230300	854
33	0114131100330300	664	0114131120330300	760	0114133000330300	854	0114133020330300	901
43	0114131100430300	714	0114131120430300	816	0114133000430300	910	0114133020430300	956
53	0114131100530300	755	0114131120530300	878	0114133000530300	985	0114133020530300	1.041
63	0114131100630300	828	0114131120630300	953	0114133000630300	1.060	0114133020630300	1.116
73	0114131100730300	912	0114131120730300	1.054	0114133000730300	1.174	0114133020730300	1.238
83	0114131100830300	974	0114131120830300	1.124	0114133000830300	1.244	0114133020830300	1.308
93	0114131100930300	1.046	0114131120930300	1.203	0114133000930300	1.351	0114133020930300	1.424
103	0114131101030300	1.111	0114131121030300	1.269	0114133001030300	1.418	0114133021030300	1.492

* Available with right-hand connection

VMF: Vertical unit with cabinet, front return air

	VE VMF - Vertical front return air		VE VMF S - Vertical, front return, soundproofed		VE VMF 4 - Vertical unit with front return, 4-pipe system		VE VMF 4/S - Vertical front intake, soundproofed, 4-pipe system	
Size	Code	£	Code	£	Code	£	Code	£
13	0114130100130300	463	0114130120130300	551	0114132300130300	631	0114132320130300	674
23	0114130100230300	486	0114130120230300	576	0114132300230300	657	0114132320230300	700
33	0114130100330300	515	0114130120330300	616	0114132300330300	704	0114132320330300	757
43	0114130100430300	565	0114130120430300	671	0114132300430300	759	0114132320430300	811
53	0114130100530300	620	0114130120530300	739	0114132300530300	842	0114132320530300	902
63	0114130100630300	691	0114130120630300	814	0114132300630300	916	0114132320630300	977
73	0114130100730300	778	0114130120730300	923	0114132300730300	1.037	0114132320730300	1.107
83	0114130100830300	842	0114130120830300	993	0114132300830300	1.107	0114132320830300	1.177
93	0114130100930300	913	0114130120930300	1.078	0114132300930300	1.222	0114132320930300	1.300
103	0114130101030300	975	0114130121030300	1.145	0114132301030300	1.289	0114132321030300	1.367

	VE VMF MB - Vertical, front return, brushless		VE VMF MB S - Vertical, front air return, soundproofed, brushless		VE VMF MB 4 - Vertical, front return, 4-pipe, brushless		VE VMF MB 4/S - Vertical front intake, soundproofed, 4-pipe brushless	
Size	Code	£	Code	£	Code	£	Code	£
13	0114131200130300	641	0114131220130300	733	0114133100130300	817	0114133120130300	856
23	0114131200230300	666	0114131220230300	759	0114133100230300	843	0114133120230300	881
33	0114131200330300	696	0114131220330300	797	0114133100330300	891	0114133120330300	938
43	0114131200430300	750	0114131220430300	851	0114133100430300	945	0114133120430300	991
53	0114131200530300	801	0114131220530300	921	0114133100530300	1.028	0114133120530300	1.084
63	0114131200630300	877	0114131220630300	997	0114133100630300	1.104	0114133120630300	1.159
73	0114131200730300	950	0114131220730300	1.104	0114133100730300	1.223	0114133120730300	1.287
83	0114131200830300	1.015	0114131220830300	1.174	0114133100830300	1.293	0114133120830300	1.357
93	0114131200930300	1.095	0114131220930300	1.260	0114133100930300	1.409	0114133120930300	1.482
103	0114131201030300	1.160	0114131221030300	1.327	0114133101030300	1.475	0114133121030300	1.549

* Available with right-hand connection

OMP: Horizontal with rear return cabinet

	VE OMP - Horizontal rear return		VE OMP S - Horizontal rear intake, silenced		VE OMP 4 - Horizontal rear return, 4-pipe		VE OMP 4/S - Horizontal, rear return, silenced, 4-pipe	
Size	Code	£	Code	£	Code	£	Code	£
13	0114130200130300	466	0114130220130300	554	0114132400130300	634	0114132420130300	677
23	0114130200230300	490	0114130220230300	581	0114132400230300	661	0114132420230300	704
33	0114130200330300	513	0114130220330300	614	0114132400330300	703	0114132420330300	755
43	0114130200430300	562	0114130220430300	669	0114132400430300	757	0114132420430300	810
53	0114130200530300	611	0114130220530300	732	0114132400530300	834	0114132420530300	895
63	0114130200630300	681	0114130220630300	806	0114132400630300	909	0114132420630300	970
73	0114130200730300	767	0114130220730300	910	0114132400730300	1.023	0114132420730300	1.094
83	0114130200830300	831	0114130220830300	980	0114132400830300	1.094	0114132420830300	1.164
93	0114130200930300	897	0114130220930300	1.060	0114132400930300	1.205	0114132420930300	1.282
103	0114130201030300	958	0114130221030300	1.126	0114132401030300	1.269	0114132421030300	1.348

	VE OMP MB - Horizontal rear return brushless		VE OMP MB S - Horizontal rear intake silenced brushless		VE OMP MB 4 - Horizontal rear return, 4-pipe brushless		VE OMP MB 4/S - Horizontal rear return, soundproofed, 4-pipe brushless	
Size	Code	£	Code	£	Code	£	Code	£
13	011413#1300130300	639	011413#1320130300	736	011413#3200130300	820	011413#3220130300	860
23	011413#1300230300	662	011413#1320230300	764	011413#3200230300	848	011413#3220230300	886
33	011413#1300330300	685	011413#1320330300	796	011413#3200330300	889	011413#3220330300	936
43	011413#1300430300	735	011413#1320430300	849	011413#3200430300	944	011413#3220430300	990
53	011413#1300530300	784	011413#1320530300	913	011413#3200530300	1.020	011413#3220530300	1.076
63	011413#1300630300	860	011413#1320630300	988	011413#3200630300	1.095	011413#3220630300	1.151
73	011413#1300730300	942	011413#1320730300	1.090	011413#3200730300	1.211	011413#3220730300	1.275
83	011413#1300830300	1.007	011413#1320830300	1.161	011413#3200830300	1.281	011413#3220830300	1.345
93	011413#1300930300	1.080	011413#1320930300	1.243	011413#3200930300	1.391	011413#3220930300	1.464
103	011413#1301030300	1.144	011413#1321030300	1.308	011413#3201030300	1.456	011413#3221030300	1.530

* Available with right-hand connection

OMI: Horizontal unit with bottom return cabinet

	VE OMI - Horizontal, bottom return		VE OMI S - Horizontal bottom silenced return		VE OMI 4 - Horizontal bottom return, 4 pipes		VE OMI 4/S - Horizontal, bottom return, soundproofed, 4-pipe	
Size	Code	£	Code	£	Code	£	Code	£
13	011413#0300130300	490	011413#0320130300	581	011413#2500130300	661	011413#2520130300	704
23	011413#0300230300	516	011413#0320230300	608	011413#2500230300	689	011413#2520230300	732
33	011413#0300330300	545	011413#0320330300	650	011413#2500330300	738	011413#2520330300	791
43	011413#0300430300	594	011413#0320430300	703	011413#2500430300	791	011413#2520430300	843
53	011413#0300530300	651	011413#0320530300	774	011413#2500530300	877	011413#2520530300	938
63	011413#0300630300	721	011413#0320630300	849	011413#2500630300	952	011413#2520630300	1.012
73	011413#0300730300	811	011413#0320730300	959	011413#2500730300	1.073	011413#2520730300	1.144
83	011413#0300830300	877	011413#0320830300	1.032	011413#2500830300	1.145	011413#2520830300	1.215
93	011413#0300930300	948	011413#0320930300	1.116	011413#2500930300	1.260	011413#2520930300	1.338
103	011413#0301030300	1.011	011413#0321030300	1.185	011413#2501030300	1.328	011413#2521030300	1.406

	VE OMI MB - Horizontal bottom return brushless		VE OMI MB S - Horizontal, bottom return, silenced, brushless		VE OMI MB 4 - Horizontal, bottom return, 4-pipe brushless		VE OMI MB 4/S - Horizontal, bottom return, silenced, 4-pipe brushless	
Size	Code	£	Code	£	Code	£	Code	£
13	011413#1400130300	663	011413#1420130300	764	011413#3300130300	848	011413#3320130300	886
23	011413#1400230300	689	011413#1420230300	791	011413#3300230300	875	011413#3320230300	913
33	011413#1400330300	724	011413#1420330300	831	011413#3300330300	924	011413#3320330300	971
43	011413#1400430300	776	011413#1420430300	883	011413#3300430300	977	011413#3320430300	1.023
53	011413#1400530300	829	011413#1420530300	956	011413#3300530300	1.063	011413#3320530300	1.119
63	011413#1400630300	908	011413#1420630300	1.032	011413#3300630300	1.139	011413#3320630300	1.194
73	011413#1400730300	984	011413#1420730300	1.140	011413#3300730300	1.260	011413#3320730300	1.324
83	011413#1400830300	1.049	011413#1420830300	1.212	011413#3300830300	1.332	011413#3320830300	1.396
93	011413#1400930300	1.127	011413#1420930300	1.298	011413#3300930300	1.447	011413#3320930300	1.520
103	011413#1401030300	1.293	011413#1421030300	1.367	011413#3301030300	1.516	011413#3321030300	1.589

* Available with right-hand connection

VE VII: Vertical built-in unit with bottom air return

	VE VII - Vertical built-in unit with bottom return air intake		VE VII S - Vertical built-in, bottom return, soundproofed		VE VII 4 - Vertical built-in unit with bottom return, 4-pipe system		VE VII 4/S - Built-in vertical, bottom return, silenced, 4-pipe system	
Size	Code	£	Code	£	Code	£	Code	£
13	011413#0400130300	346	011413#0420130300	422	011413#2600130300	501	011413#2620130300	544
23	011413#0400230300	369	011413#0420230300	448	011413#2600230300	527	011413#2620230300	570
33	011413#0400330300	372	011413#0420330300	460	011413#2600330300	547	011413#2620330300	600
43	011413#0400430300	423	011413#0420430300	514	011413#2600430300	602	011413#2620430300	655
53	011413#0400530300	457	011413#0420530300	561	011413#2600530300	663	011413#2620530300	724
63	011413#0400630300	537	011413#0420630300	634	011413#2600630300	736	011413#2620630300	797
73	011413#0400730300	603	011413#0420730300	718	011413#2600730300	832	011413#2620730300	902
83	011413#0400830300	683	011413#0420830300	788	011413#2600830300	902	011413#2620830300	973
93	011413#0400930300	735	011413#0420930300	851	011413#2600930300	994	011413#2620930300	1.073
103	011413#0401030300	795	011413#0421030300	918	011413#2601030300	1.062	011413#2621030300	1.140

	VE VII MB - Vertical built-in unit with bottom return, brushless		VE VII MB S - Recessed vertical unit with bottom return, brushless, soundproof		VE VII MB 4 - Built-in vertical unit with bottom return, 4-pipe brushless, low-noise		VE VII MB 4 S - Vertical ducted vertical concealed unit with lower return, enhanced brushless	
Size	Code	£	Code	£	Code	£	Code	£
13	011413#1500130300	531	011413#1520130300	604	011413#3400130300	689	011413#3420130300	727
23	011413#1500230300	549	011413#1520230300	629	011413#3400230300	714	011413#3420230300	752
33	011413#1500330300	557	011413#1520330300	640	011413#3400330300	735	011413#3420330300	781
43	011413#1500430300	609	011413#1520430300	695	011413#3400430300	788	011413#3420430300	835
53	011413#1500530300	641	011413#1520530300	742	011413#3400530300	849	011413#3420530300	906
63	011413#1500630300	724	011413#1520630300	816	011413#3400630300	923	011413#3420630300	979
73	011413#1500730300	791	011413#1520730300	899	011413#3400730300	1.019	011413#3420730300	1.083
83	011413#1500830300	870	011413#1520830300	970	011413#3400830300	1.089	011413#3420830300	1.153
93	011413#1500930300	921	011413#1520930300	1.034	011413#3400930300	1.182	011413#3420930300	1.255
103	011413#1501030300	981	011413#1521030300	1.101	011413#3401030300	1.249	011413#3421030300	1.322

	VE VII P - Recessed vertical unit with enhanced bottom return		VE VII 4/P - Vertical built-in unit with bottom return, 4-pipe, high-capacity		VE VII MB P - Built-in vertical, enhanced brushless, bottom return		VE VII MB 4/P - Vertical built-in unit, bottom return, brushless, boosted 4-pipe system	
Size	Code	£	Code	£	Code	£	Code	£
13	011413#0410130300	416	011413#2610130300	538	011413#1510130300	585	011413#3410130300	707
23	011413#0410230300	440	011413#2610230300	564	011413#1510230300	610	011413#3410230300	733
33	011413#0410330300	476	011413#2610330300	616	011413#1510330300	613	011413#3410330300	753
43	011413#0410430300	530	011413#2610430300	671	011413#1510430300	668	011413#3410430300	808
53	011413#0410530300	568	011413#2610530300	732	011413#1510530300	706	011413#3410530300	869
63	011413#0410630300	642	011413#2610630300	805	011413#1510630300	779	011413#3410630300	942
73	011413#0410730300	717	011413#2610730300	901	011413#1510730300	854	011413#3410730300	1.038
83	011413#0410830300	787	011413#2610830300	971	011413#1510830300	924	011413#3410830300	1.108
93	011413#0410930300	935	011413#2610930300	1.162	011413#1510930300	1.278	011413#3410930300	1.499
103	011413#0411030300	1.000	011413#2611030300	1.229	011413#1511030300	1.345	011413#3411030300	1.566

* Available with right-hand connection

VE VIF: Vertical built-in unit with front return air intake

	VE VIF - Vertical built-in unit with front air return		VE VIF S - Vertical built-in front intake silenced unit		VE VIF 4 - Vertical recessed unit with front return, 4-pipe system		VE VIF 4/S - Vertical built-in, front return, silenced, 4-pipe system	
Size	Code	£	Code	£	Code	£	Code	£
13	011413#0500130300	350	011413#0520130300	426	011413#2700130300	506	011413#2720130300	549
23	011413#0500230300	375	011413#0520230300	454	011413#2700230300	533	011413#2720230300	576
33	011413#0500330300	385	011413#0520330300	465	011413#2700330300	553	011413#2720330300	605
43	011413#0500430300	427	011413#0520430300	521	011413#2700430300	608	011413#2720430300	661
53	011413#0500530300	461	011413#0520530300	565	011413#2700530300	668	011413#2720530300	728
63	011413#0500630300	538	011413#0520630300	640	011413#2700630300	742	011413#2720630300	803
73	011413#0500730300	604	011413#0520730300	725	011413#2700730300	838	011413#2720730300	909
83	011413#0500830300	680	011413#0520830300	797	011413#2700830300	910	011413#2720830300	980
93	011413#0500930300	735	011413#0520930300	856	011413#2700930300	1.000	011413#2720930300	1.078
103	011413#0501030300	802	011413#0521030300	923	011413#2701030300	1.067	011413#2721030300	1.145

	VE VIF MB - Vertical built-in unit with front return, brushless motor		VE VIF MB S – Vertical recessed, front return, brushless, soundproofed		VE VIF MB 4 - Vertical recessed front return 4-pipe silent brushless unit		VE VIF MB 4 S - Built-in vertical, front return, enhanced brushless	
Size	Code	£	Code	£	Code	£	Code	£
13	011413#1600130300	534	011413#1620130300	608	011413#3500130300	693	011413#3520130300	732
23	011413#1600230300	557	011413#1620230300	636	011413#3500230300	720	011413#3520230300	759
33	011413#1600330300	571	011413#1620330300	645	011413#3500330300	739	011413#3520330300	785
43	011413#1600430300	613	011413#1620430300	701	011413#3500430300	796	011413#3520430300	842
53	011413#1600530300	646	011413#1620530300	747	011413#3500530300	854	011413#3520530300	910
63	011413#1600630300	726	011413#1620630300	822	011413#3500630300	930	011413#3520630300	985
73	011413#1600730300	792	011413#1620730300	906	011413#3500730300	1.025	011413#3520730300	1.089
83	011413#1600830300	868	011413#1620830300	977	011413#3500830300	1.097	011413#3520830300	1.161
93	011413#1600930300	921	011413#1620930300	1.038	011413#3500930300	1.186	011413#3520930300	1.260
103	011413#1601030300	988	011413#1621030300	1.105	011413#3501030300	1.254	011413#3521030300	1.327

	VE VIF P - Enhanced vertical recessed unit with front return air		VE VIF 4/P - Vertical built-in front return, enhanced 4-pipe system		VE VIF MB P – Vertical concealed unit with frontal return, enhanced brushless		VE VIF MB 4/P - Vertical recessed front-return brushless enhanced 4-pipe unit	
Size	Code	£	Code	£	Code	£	Code	£
13	011413#0510130300	420	011413#2710130300	543	011413#1610130300	590	011413#3510130300	712
23	011413#0510230300	448	011413#2710230300	570	011413#1610230300	616	011413#3510230300	739
33	011413#0510330300	480	011413#2710330300	622	011413#1610330300	618	011413#3510330300	759
43	011413#0510430300	536	011413#2710430300	677	011413#1610430300	674	011413#3510430300	814
53	011413#0510530300	573	011413#2710530300	736	011413#1610530300	710	011413#3510530300	874
63	011413#0510630300	648	011413#2710630300	811	011413#1610630300	785	011413#3510630300	948
73	011413#0510730300	724	011413#2710730300	907	011413#1610730300	861	011413#3510730300	1.044
83	011413#0510830300	796	011413#2710830300	979	011413#1610830300	933	011413#3510830300	1.116
93	011413#0510930300	952	011413#2710930300	1.167	011413#1610930300	1.282	011413#3510930300	1.217
103	011413#0511030300	1.016	011413#2711030300	1.234	011413#1611030300	1.350	011413#3511030300	1.284

* Available with right-hand connection

OIP: Horizontal recessed unit with rear return air

	VE OIP - Horizontal recessed unit with rear return air		VE OIP S - Horizontal built-in rear intake, soundproofed		VE OIP 4 - Horizontal recessed unit with rear return, 4-pipe system		VE OIP 4/S - Horizontal concealed rear return silenced 4-pipe unit	
Size	Code	£	Code	£	Code	£	Code	£
13	011413#0600130300	352	011413#0620130300	426	011413#2800130300	506	011413#2820130300	549
23	011413#0600230300	376	011413#0620230300	454	011413#2800230300	533	011413#2820230300	576
33	011413#0600330300	384	011413#0620330300	465	011413#2800330300	553	011413#2820330300	605
43	011413#0600430300	429	011413#0620430300	521	011413#2800430300	608	011413#2820430300	661
53	011413#0600530300	463	011413#0620530300	565	011413#2800530300	668	011413#2820530300	728
63	011413#0600630300	538	011413#0620630300	640	011413#2800630300	742	011413#2820630300	803
73	011413#0600730300	607	011413#0620730300	725	011413#2800730300	838	011413#2820730300	909
83	011413#0600830300	686	011413#0620830300	797	011413#2800830300	910	011413#2820830300	980
93	011413#0600930300	735	011413#0620930300	856	011413#2800930300	1.000	011413#2820930300	1.078
103	011413#0601030300	798	011413#0621030300	923	011413#2801030300	1.067	011413#2821030300	1.145

	VE OIP MB – Horizontal recessed unit with rear return, brushless		VE OIP MB S - Horizontal built-in unit with rear return, brushless, soundproofed		VE OIP MB 4 - Horizontal recessed unit with rear return, 4-pipe brushless, soundproofed		VE OIP MB 4 S - Horizontal built-in unit with rear return, enhanced brushless	
Size	Code	£	Code	£	Code	£	Code	£
13	011413#1700130300	534	011413#1720130300	608	011413#3600130300	693	011413#3620130300	732
23	011413#1700230300	558	011413#1720230300	636	011413#3600230300	720	011413#3620230300	759
33	011413#1700330300	570	011413#1720330300	645	011413#3600330300	739	011413#3620330300	785
43	011413#1700430300	609	011413#1720430300	701	011413#3600430300	796	011413#3620430300	842
53	011413#1700530300	650	011413#1720530300	747	011413#3600530300	854	011413#3620530300	910
63	011413#1700630300	726	011413#1720630300	822	011413#3600630300	930	011413#3620630300	985
73	011413#1700730300	795	011413#1720730300	906	011413#3600730300	1.025	011413#3620730300	1.089
83	011413#1700830300	873	011413#1720830300	977	011413#3600830300	1.097	011413#3620830300	1.161
93	011413#1700930300	921	011413#1720930300	1.038	011413#3600930300	1.186	011413#3620930300	1.260
103	011413#1701030300	985	011413#1721030300	1.105	011413#3601030300	1.254	011413#3621030300	1.327

	VE OIP P - Horizontal built-in rear return enhanced		VE OIP 4/P - Horizontal recessed unit with rear return, 4-pipe enhanced		VE OIP MB P - Horizontal ducted unit with rear return, enhanced brushless		VE OIP MB 4/P - Horizontal concealed unit with rear return, brushless, enhanced 4-pipe system	
Size	Code	£	Code	£	Code	£	Code	£
13	011413#0610130300	420	011413#2810130300	543	011413#1710130300	590	011413#3610130300	712
23	011413#0610230300	448	011413#2810230300	570	011413#1710230300	616	011413#3610230300	739
33	011413#0610330300	480	011413#2810330300	622	011413#1710330300	618	011413#3610330300	759
43	011413#0610430300	536	011413#2810430300	677	011413#1710430300	674	011413#3610430300	814
53	011413#0610530300	573	011413#2810530300	736	011413#1710530300	710	011413#3610530300	874
63	011413#0610630300	648	011413#2810630300	811	011413#1710630300	785	011413#3610630300	948
73	011413#0610730300	724	011413#2810730300	907	011413#1710730300	861	011413#3610730300	1.044
83	011413#0610830300	796	011413#2810830300	979	011413#1710830300	933	011413#3610830300	1.116
93	011413#0610930300	940	011413#2810930300	1.167	011413#1710930300	1.282	011413#3610930300	1.504
103	011413#0611030300	1.005	011413#2811030300	1.234	011413#1711030300	1.350	011413#3611030300	1.571

* Available with right-hand connection

OII: Horizontal concealed unit with bottom return air intake

	VE OII - Horizontal concealed unit with bottom return air intake		VE OII S - Horizontal recessed unit with bottom return, soundproofed		VE OII 4 - Horizontal recessed unit bottom return, 4-pipe system		VE OII 4/S - Horizontal recessed, bottom return, silenced, 4-pipe	
Size	Code	£	Code	£	Code	£	Code	£
13	011413#0700130300	356	011413#0720130300	433	011413#2900130300	512	011413#2920130300	556
23	011413#0700230300	378	011413#0720230300	458	011413#2900230300	538	011413#2920230300	581
33	011413#0700330300	384	011413#0720330300	472	011413#2900330300	561	011413#2920330300	613
43	011413#0700430300	432	011413#0720430300	526	011413#2900430300	613	011413#2920430300	666
53	011413#0700530300	473	011413#0720530300	570	011413#2900530300	672	011413#2920530300	733
63	011413#0700630300	547	011413#0720630300	645	011413#2900630300	747	011413#2920630300	808
73	011413#0700730300	622	011413#0720730300	732	011413#2900730300	845	011413#2920730300	915
83	011413#0700830300	686	011413#0720830300	802	011413#2900830300	915	011413#2920830300	985
93	011413#0700930300	742	011413#0720930300	864	011413#2900930300	1.008	011413#2920930300	1.086
103	011413#0701030300	802	011413#0721030300	930	011413#2901030300	1.073	011413#2921030300	1.151

	VE OII MB - Horizontal built-in unit with bottom return, brushless		VE OII MB S - Horizontal ducted concealed unit with bottom return, brushless, soundproofed		VE OII MB 4 - Horizontal built-in unit with bottom return, 4-pipe, brushless, soundproofed		VE OII MB 4 S - Horizontal ducted built-in unit, bottom return, enhanced brushless	
Size	Code	£	Code	£	Code	£	Code	£
13	011413#1800130300	543	011413#1820130300	614	011413#3700130300	700	011413#3720130300	738
23	011413#1800230300	567	011413#1820230300	640	011413#3700230300	725	011413#3720230300	764
33	011413#1800330300	572	011413#1820330300	654	011413#3700330300	747	011413#3720330300	794
43	011413#1800430300	622	011413#1820430300	706	011413#3700430300	800	011413#3720430300	846
53	011413#1800530300	659	011413#1820530300	752	011413#3700530300	860	011413#3720530300	915
63	011413#1800630300	734	011413#1820630300	828	011413#3700630300	934	011413#3720630300	990
73	011413#1800730300	807	011413#1820730300	912	011413#3700730300	1.032	011413#3720730300	1.095
83	011413#1800830300	873	011413#1820830300	982	011413#3700830300	1.102	011413#3720830300	1.165
93	011413#1800930300	930	011413#1820930300	1.046	011413#3700930300	1.194	011413#3720930300	1.268
103	011413#1801030300	988	011413#1821030300	1.112	011413#3701030300	1.260	011413#3721030300	1.333

	VE OII P - Horizontal built-in unit with enhanced bottom return air		VE OII 4/P - Horizontal built-in unit with bottom return, enhanced 4-pipe system		VE OII MB P - Horizontal recessed unit with bottom return, enhanced brushless		VE OII MB 4/P - Horizontal built-in unit, bottom return, brushless, enhanced 4-pipe system	
Size	Code	£	Code	£	Code	£	Code	£
13	011413#0710130300	426	011413#2910130300	549	011413#1810130300	596	011413#3710130300	718
23	011413#0710230300	452	011413#2910230300	575	011413#1810230300	622	011413#3710230300	744
33	011413#0710330300	489	011413#2910330300	629	011413#1810330300	626	011413#3710330300	767
43	011413#0710430300	541	011413#2910430300	682	011413#1810430300	678	011413#3710430300	819
53	011413#0710530300	578	011413#2910530300	741	011413#1810530300	715	011413#3710530300	878
63	011413#0710630300	654	011413#2910630300	816	011413#1810630300	791	011413#3710630300	953
73	011413#0710730300	730	011413#2910730300	913	011413#1810730300	867	011413#3710730300	1.051
83	011413#0710830300	800	011413#2910830300	984	011413#1810830300	938	011413#3710830300	1.121
93	011413#0710930300	957	011413#2910930300	1.176	011413#1810930300	1.290	011413#3710930300	1.225
103	011413#0711030300	1.022	011413#2911030300	1.241	011413#1811030300	1.356	011413#3711030300	1.290

* Available with right-hand connection

ACCESSORIES				
		Compatibility	Code	£
2V2	2-way valves for 2-pipe system with 230V actuator	13-103	011993380000	147
2V4	2-way valves for 4-pipe system with 230V actuator		011993400000	318
3V2	3-way valves for 2-pipe systems with 230V actuator		011993370000	147
3V4	3-way valves for 4-pipe systems with 230V actuator		011993390000	364
CBB	On-unit controller for brushless motor, 2/4-pipe system management with/without valves		011993570000	280
CRA	Electronic thermostat for fan coil units		011993600000	102
CVA	On-unit 3-speed control		011993540000	42
CVB	On-unit 3-speed control + summer/winter selector switch + room thermostat		011993550000	101
CVC	On-board electronic unit control 230Vac with OFF/Cooling/Heating + 3 speeds + thermostat		011993580000	115
CVD1	Microprocessor machine-mounted control 230Vac + 2/4-pipe management with/without valves		011993590000	215
MOR	"Mamut"-type terminal block		011993630000	11
P	Feet		011993500000	40
SDI.4X3A	Board with 4 outputs (4 motors, 3 speeds) rated 3 A		0119950076020	266
TEL	System for remote control management			311
TMB	Minimum thermostat		011993620000	41
VA	Auxiliary drain pan for vertical versions		011993530000	29
3V2-25-1NO	3-way valve for 2-pipe systems with end-of-stroke microswitch (4-wire)	13-103	011993840000	238
FTI	Galvanized recessed subframe for VIP versions	13-23	011993641323	81
		33-43	011993643343	104
		53-63	011993645363	123
		73-83	011993647383	145
		93-103	011993649303	165
P1	Panel for VIP/ONP version	13-23	011993411323	101
		33-43	011993413343	123
		53-63	011993415363	149
		73-83	011993417383	180
P2	Panel for VIP2 version with control door	93-103	011993419303	201
		13-23	011993421323	108
		33-43	011993423343	138
		53-63	011993425363	158
PA	Plenum with circular suction connections	73-83	011993427383	187
		93-103	011993429303	211
		13-23	011993471323	118
		33-43	011993473343	147
PCB	Lower closing panel without grille in pre-painted sheet metal	53-63	011993475363	170
		73-83	011993477383	198
		93-103	011993479303	224
		13-23	011993451323	34
		33-43	011993453343	42
		53-63	011993455363	51
		73-83	011993457383	61
		93-103	011993459303	65

ACCESSORIES				
		Compatibility	Code	£
PCPB	Middle rear closing panel in pre-painted sheet metal	13-23	011993441323	53
		33-43	011993443343	68
		53-63	011993445363	84
		73-83	011993447383	99
		93-103	011993449303	111
PCPF	Lower rear closing panel in pre-painted sheet metal	13-23	011993431323	51
		33-43	011993433343	63
		53-63	011993435363	77
		73-83	011993437383	93
		93-103	011993439303	102
PMI	90° supply plenum for VIP and ONP versions with insulation	13-23	011993651323	69
		33-43	011993653343	85
		53-63	011993655363	101
		73-83	011993657383	116
		93-103	011993659303	133
PM	Supply plenum with circular outlets	13-23	011993461323	117
		33-43	011993463343	132
		53-63	011993465363	147
		73-83	011993467383	167
		93-103	011993469303	182
PMP1	Condensate lifting pump with 8A alarm contact for vertical VE units	13-103	011993810000	400
PMP2	Condensate lifting pump with 8A alarm contact for horizontal VEs		011993820000	391

*incompatible with TMB or MOR-TMB or STLS
For the wired controller price lists, refer to the pages at the beginning of the chapter.

MI A3

Hydronic wall panels

2.7 kW–4.4 kW

Designed to fully meet efficiency, low-noise, and aesthetic requirements. The microprocessor control ensures precise comfort in the room. Three-way valve installed on board the unit. ABS casing with high mechanical strength and excellent ageing resistance; DC brushless fan motor; water coil with large heat exchange surface equipped with air vent valve and condensate drain; horizontal fins and independent vertically adjustable deflectors; complete function management via LCD remote control; cooling and heating operation with three fan speeds plus Auto mode. Manual restart function and Timer function.



As standard:

Three-way 230 V diverter valve with compact-type electric actuator, normally closed and equipped with protective cover, air bleed valve, LCD remote control, volt-free contact for remote ON-OFF, ModBus input, condensate collection tray and drain.

Limit Switch Micro Switch

The unit is equipped with a limit micro switch installed on the three-way diverter valve. This micro switch is wired to a dedicated terminal block from which the signal can be used for various purposes. In particular, this volt-free contact is useful for implementing system automation functions.

Accessories

- **WGC8:** LAN gateway centralizer for remote management via App
- **WRC11:** Compact multifunction wired controller
- **WRC16:** Allows control of up to 16 indoor units using a single wired controller via the XYE ports.

			26A3	35A3	42A3
Cooling	(1) Cooling capacity	kW	2,7/2,59/2,39	3,81/3,3/2,88	4,47/3,98/3,48
		kBTU/h	9,2/8,8/8,1	12/11,2/9,8	15,2/13,5/11,8
	Power input	W	13/11/10	34/22/15	26/18/13
	Water flow rate	m³/h	0,48/0,46/0,42	0,67/0,57/0,51	0,77/0,68/0,61
	Water pressure losses	kPa	31,61/28,63/25,36	56,75/41,23/33,02	41,17/33,54/27,05
Heating	(2) Heating capacity	kW	2,94/2,8/2,58	4,3/3,65/3,09	4,84/4,23/3,62
		kBTU/h	10/9,5/8,8	14,6/12,4/10,5	16,5/14,4/12,3
	Power input	W	11/11/9	31/20/14	22/16/12
	Water flow rate	m³/h	0,51/0,49/0,46	0,73/0,64/0,56	0,84/0,73/0,64
	Water pressure losses	kPa	32,66/34,89/30,24	51,86/47,53/35,69	36,82/33,83/26,26
Sound data	(3) Maximum–medium–minimum sound pressure	dB(A)	32/30/27	45/39/35	38/34/30
	Hydraulic connections	Ø	3/4"	3/4"	3/4"
Power supply	Airflow	m³/h	492/454/400	825/689/590	862/741/634
	Power supply	V~/Ph/Hz	230/1/50		
	Absorbed current	A	0,2	0,4	0,3
	Rows		2	2	2
Heat exchange coil	Max. pressure	MPa	1.6		
	Diameter	mm	Ø7		
	Condensate drain	mm	OD Ø20		
	Heat exchanger coil length	mm	635x26.74		785x26.74
	Fin type		Hydrophilic aluminum		
	No. of circuits		5	5	7

Not equipped with a condensate drain pump.

(1) Cooling capacity: Inlet air temperature: 27°C d.b. / 19°C w.b.

Water inlet/outlet temperature: 7°C / 12°C

(2) Heating capacity: Inlet air temperature: 20°C d.b.

Water inlet/outlet temperature: 45°C / 40°C

(3) Noise level tested in a semi-anechoic chamber.

Dimensional Drawings

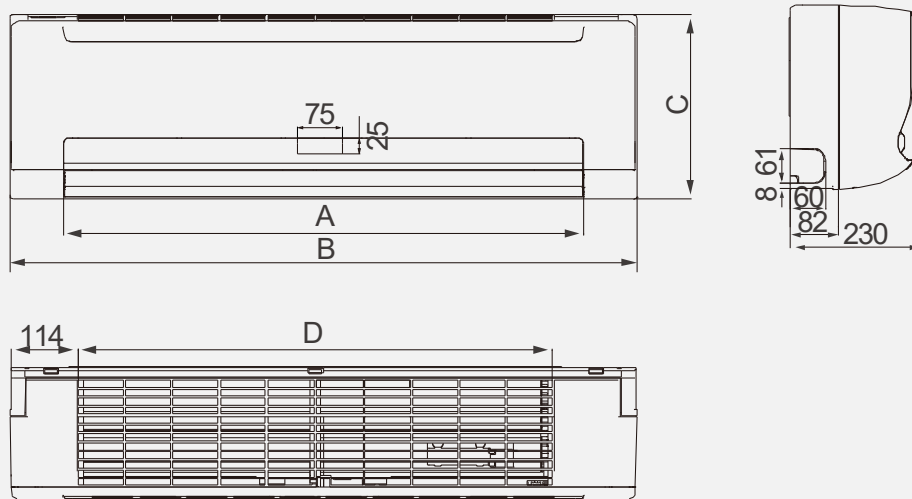

	26A3	35A3	42A3
A	732	732	892
B	915	915	1.072
C	290	290	315
D	663	663	813
Kg	12,7	12,7	15,1

Dimensions in mm

Left-hand side hydraulic connections

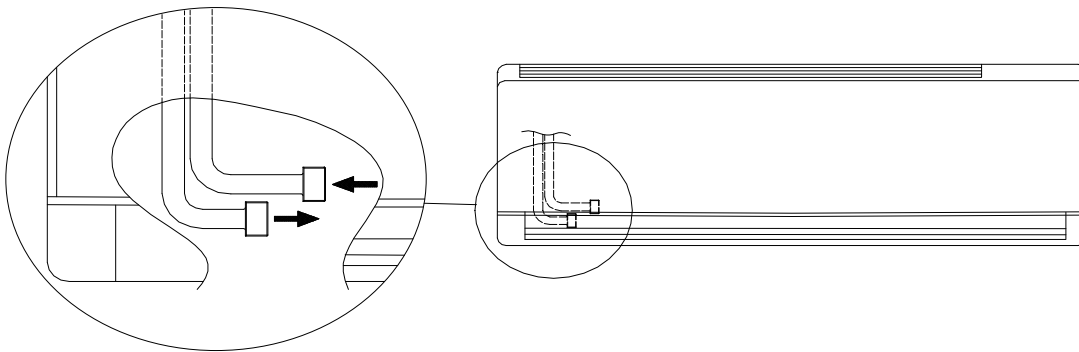

Price list

MI A3		26A3	35A3	42A3	
Hydronic wall-mounted unit		code	011422020026	011422020035	011422020042
		£	801	885	1.108
ACCESSORIES			Code	£	
WGC8	LAN gateway central controller for remote management via App. Up to 64 units connectable.		012109010099	1.226	
WRC11	Compact multifunction wired controller		012108010034	166	
WRC16	Allows control of up to 16 indoor units by means of a single wired remote controller via the XYE terminals.		012108010095	205	

HCA1 - HCA1/4

Hydronic DC brushless cassettes

2.0 kW–6.1 kW

MAXA hydronic cassettes with DC brushless motor are designed to fully meet the efficiency, low-noise and aesthetic requirements demanded by the market. The microprocessor control ensures precise comfort in the room. The ModBus input allows quick integration with external BMS systems.

The compact dimensions meet installation needs in false ceilings thanks to the reduced sizes of 57 x 57 cm or 84 x 84 cm in the higher-capacity versions.

Provision for local adjacent air supply (size 60 only) and for fresh air intake (all sizes).



Unit composition:

- High-efficiency finned coils with low pressure drops.
- Internal closed-cell insulation to minimize thermal loss and acoustic emission.
- Automatic flap movement.
- Condensate lift pump up to a maximum height of 500 mm, supplied as standard
- Modbus input

Valve kit *

- 3V2C: 3-way 2-pipe valve kit (HCA 22-29-35-42)
- 3V2CG: 3-way valve kit for 2-pipe systems (HCA 60)
- 3V4C: 3-way valve kit, 4-pipe system (HCA 22-35-50)
- 3V4CG: 4-pipe 3-way valve kit (HCA 60)

Valve kit for systems with modulating pump

- 2V2C: 2-way valve kit for 2-pipe system (HCA 22-29-35-42)
- 2V2CG: 2-way valve kit, 2-pipe (HCA 60)
- 2V4C: 2-way 4-pipe valve kit (HCA 35-50)
- 2V4CG: 2-way valve kit, 4-pipe system (HCA 60)

3-way / 2-way valve kit *

The kit consists of:

- No. 2 nipples / No. 1 nipple
- no. 4 O-rings / no. 2 O-rings
- No. 2 copper connection pipes / No. 1 copper connection pipe
- No. 1 three-way valve body – 4 ports / No. 1 two-way valve body – 2 ports
- No. 1 ON/OFF actuator / No. 1 ON/OFF actuator

* For optimal operation it is always necessary to connect the water shut-off valve(s). In the absence of this device, room temperature control may not be guaranteed.

Accessories

- **WGC8:** LAN gateway centralizer for remote management via App
- **WRC11:** Compact multifunction wired controller
- **WRC16:** Allows control of up to 16 indoor units using a single wired controller via the XYE ports.

Versions

- **HCA1:** Cassette unit for 2-pipe system with electronic control and remote control
- **HCA1/4:** Cassette unit for 4-pipe system with electronic control and remote control



2V4C/2V4CG



3V4C

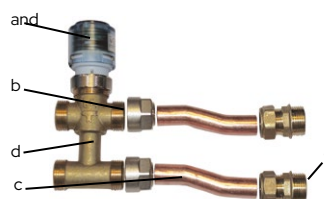

3V2C/3V2CG

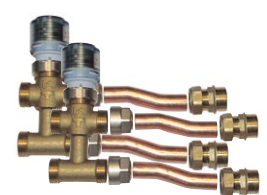

3V4CG

			22	29	35	42	60
HCA1	(1) Cooling capacity	W	2.000	2.980	3.960	4.200	6.120
		BTU/h	6.826	10.171	13.515	14.335	20.888
	Water flow rate	m ³ /h	0,35	0,53	0,7	0,75	1,1
	(1) Power input	W	5	15	28	43	75
	(2) Heating capacity	W	2.240	2.610	4.630	4.950	6.270
		BTU/h	7.645	8.908	15.802	16.894	21.400
	Water flow rate	m ³ /h	0,35	0,53	0,7	0,75	1,1
	(2) Power input	W	5	15	28	33	76
	Maximum - medium - minimum sound pressure (3)	dB(A)	39/33/27	39/33/27	42/36/30	43/38/32	44/40/34
	Maximum - medium - minimum sound power (3)	dB(A)	51/45/39	51/45/39	54/48/42	55/50/44	-
Airflow rate	m ³ /h	322	535	719	781	1229	
Fan type		Centrifugal					
No. of rows		2					
Electric motor		DC					

			35	50	60
HCA1/4	(1) Cooling capacity	W	3.080	3.050	5.620
		BTU/h	10.512	10.410	19.181
	Water flow rate	m ³ /h	0,56	0,54	1,04
	(1) Power input	W	37	32	60
	(2) Heating capacity	W	5.520	5.970	7.660
		BTU/h	18.840	20.376	26.144
	Water flow rate	m ³ /h	0,42	0,46	0,73
	(2) Power input	W	28	32	61
	Maximum - medium - minimum sound pressure (3)	dB(A)	42/35/30	44/39/31	44/39/33
	Airflow rate	m ³ /h	723	731	1389
Fan type		Centrifugal			
No. of rows (cooling / heating)		4/3	4/3	9/3	
Electric motor		DC			

(1) Inlet air temperature: 27°C d.b./19.5°C w.b. at maximum speed
 Entering/leaving water temperature: 7°C / 12°C at maximum speed
 (2) Inlet air temperature: 20°C d.b. at maximum speed
 Inlet water temperature: 50°C at maximum speed

(3) At a distance of 1 m and a reverberation time of 0.5 s, maximum velocity

Dimensional Drawings

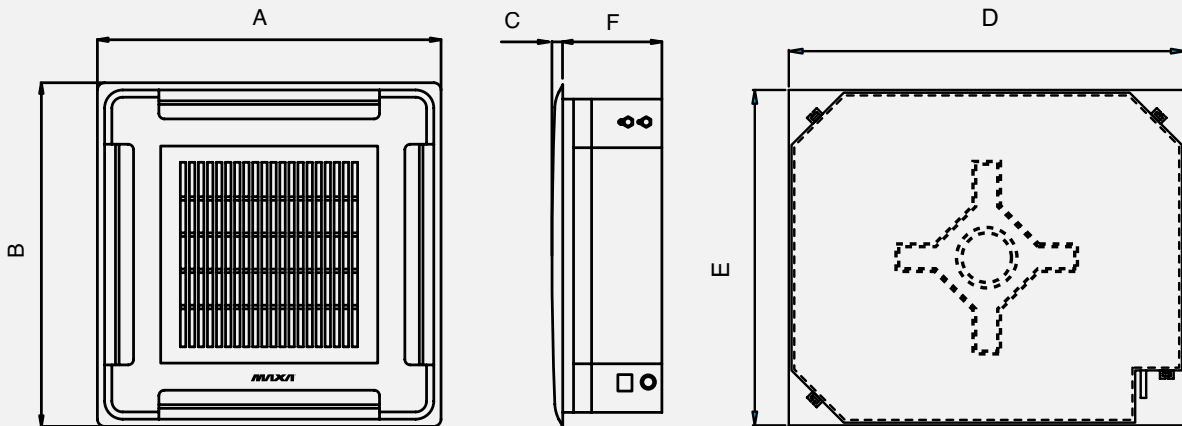

	HCA1 22	HCA1 29	HCA1 35 HCA1/4 35	HCA1 42 HCA1/4 50	HCA1 60 HCA1/4 60
A	647	647	647	647	950
B	647	647	647	647	950
C	50	50	50	50	45
D	575	575	575	575	840
E	575	575	575	575	840
F	261	261	261	261	300
Kg	19	19	19	19	33,5

Dimensions in mm

Price list

HCA1			22	29	35	42	60
Cassette unit for 2-pipe system with electronic control and remote control	Body Code		0111318010022	0111318010029	0111318010035	0111318010042	0111318010060
	Panel Code		010132518010	010132518010	010132518010	010132518010	010132518030
	Drip Tray Code		010132519010	010132519010	010132519010	010132519010	010132519030
	£		959	1.004	1.041	1.125	1.468
HCA1 ACCESSORIES							
2V2C*	2-way valve kit	code	0119100015	0119100015	0119100015	0119100015	-
		£	71	71	71	71	-
2V2CG*	2-way valve kit	code	-	-	-	-	0119100020
		£	-	-	-	-	71
3V2C*	3-way valve kit	code	0119100013	0119100013	0119100013	0119100013	-
		£	105	105	105	105	-
3V2CG*	3-way valve kit (mandatory accessory)	code	-	-	-	-	0119100019
		£	-	-	-	-	82
WGC8	LAN gateway central controller for remote management via App. Up to 64 units connectable.	code	012109010099				
		£	1.226				
WRC11	Compact multifunction wired controller	code	012108010034				
		£	166				
WRC16	Allows control of up to 16 indoor units by means of a single wired remote controller via the XYE terminals.	code	012108010095				
		£	205				

* To be assembled on site

HCA1/4			35	50	60
Cassette unit for 4-pipe system with electronic control and remote control	Body Code		0111318030035	0111318030050	0111318030060
	Panel Code		010132518010	010132518010	010132518030
	Drip Tray Code		010132519010	010132519010	010132519030
	£		1.308	1.412	1.860
ACCESSORIES					
2V4C*	2-way, 4-pipe valve kit	code	0119100016	0119100016	-
		£	135	135	-
2V4CG*	2-way 4-pipe valve kit (mandatory accessory)	code	-	-	0119100022
		£	-	-	117
3V4C*	4-pipe 3-way valve kit	code	0119100014	0119100014	-
		£	191	191	-
3V4CG*	4-pipe 3-way valve kit (mandatory accessory)	code	-	-	0119100021
		£	-	-	153
WGC8	LAN gateway central controller for remote management via App. Up to 64 units connectable.	code	012109010099		
		£	1.226		
WRC11	Compact multifunction wired controller	code	012108010034		
		£	166		
WRC16	Allows control of up to 16 indoor units by means of a single wired remote controller via the XYE terminals.	code	012108010095		
		£	205		

* To be assembled on site

HCN

Low-profile ductable units with asynchronous AC or brushless DC motor

6 kW–20 kW

- Self-supporting structure in galvanized sheet metal with thermal and acoustic insulation (S version) or double 20 mm sandwich panel with pre-painted external sheet metal in white RAL 9002 (D version); equipped with ceiling/wall mounting holes, compact dimensions and optimized overall footprint.
- Double-slope condensate collection tray.
- High-efficiency heat exchange coil with copper tubes and aluminum fins, standard connections on the right-hand side.
- Double inlet centrifugal fans with plastic impellers featuring forward-curved, airfoil blades of large diameter, mounted on elastic supports and vibration dampers.
- The unit is equipped with an IP20 “Mammut”-type terminal block mounted outside the unit.
- The ductable units of the HCN series are supplied without an air filter. A wide range of filters is available in the accessories section.



Configurations

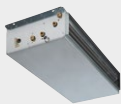

S-OIP

Single recessed horizontal panel with rear return air intake

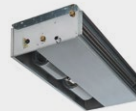

S-OII

Single recessed horizontal panel with bottom return



D-OIP

Double panel, horizontal recessed units with rear return air

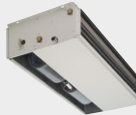

D-OII

Double panel, horizontal recessed units with bottom return

Versions

- **S-OIP**: Single concealed horizontal unit, rear return panel
- **D-OIP**: Double panel, horizontal recessed units with rear return air intake
- **S-OII**: Single recessed horizontal panel with bottom return
- **D-OII**: Double panel, horizontal recessed units with bottom return air

Standard with connection on the left. When ordering, it is possible to request connections on the right side.

Nomenclature

When ordering, always specify the full model as shown in the example below.

HCN	-	S	-	OIP	-	130	-	DX
Series		Load-bearing casing		Version		Size		Connections
HCN		S; D		OIP-OII		60.....200		DX; SX

HCN-S-OIP 130-DX

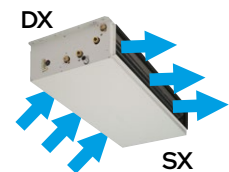

For accessories, see the “HCN - HCNP Accessories” page.

HCN			60	75	86	103	130	136	150	170	200
	Cooling capacity (1) (*)	W	6.010	7.480	8.590	10.300	12.900	13.600	15.000	17.200	20.200
	Sensible capacity (1) (*)	W	4.570	5.560	6.160	8.100	9.950	10.800	11.100	13.300	14.900
	Thermal output (2) (*)	W	6.550	7.900	8.300	11.700	14.400	15.650	15.200	19.400	20.400
	Thermal output (3) (*)	W	13.100	15.800	16.600	23.400	28.800	31.300	30.400	38.800	40.800
	Air flow rate (4)	m³/h	1.100	1.200	1.150	2.100	2.300	2.800	2.200	3.100	2.950
	Sound pressure Min-Med-Max (5)	dB(A)	37-44-49	38-45-50	38-45-50	45-50-52	46-51-53	41-48-51	46-51-53	42-49-52	42-49-52
	Nominal electrical power input	W	200	200	200	340	340	340	320	320	320
	Rated current	A	0,9	0,9	0,9	1,65	1,65	1,65	1,50	1,50	1,50
	No. of motors / no. of fans		1 / 1	1 / 1	1 / 1	1 / 2	1 / 2	1 / 2	1 / 3	1 / 3	1 / 3
	Maximum available static pressure	Pa	148	152	152	138	142	142	132	136	136
Combined heating/ cooling coil hot/cold	no. of rows	no.	3	3	4	3	3	4	3	3	4
	hydraulic connection	Ø	3/4" F	3/4" F	3/4" F	3/4" F	3/4" F	3/4" F	3/4" F	3/4" F	3/4" F
	water content	L	1,95	1,96	2,60	2,86	2,87	3,82	3,75	3,76	4,99
Heat outputs in 4-pipe version (HCN + BC)											
	HCN		60	75	86	103	130	136	150	170	200
	Cooling capacity (1) (*)	W	5.830	7.220	-	9.960	12.400	-	13.200	16.600	-
	Sensible capacity (1) (*)	W	4.220	5.350	-	7.830	9.530	-	10.400	12.800	-
	Heating capacity (3)	W	6.610	6.970	-	11.600	12.200	-	15.500	16.400	-
	Air flow rate (4)	m³/h	1.050	1.140	-	2.000	2.170	-	2.670	2.930	-
	Maximum available static pressure	Pa	148	152	-	138	142	-	134	138	-

Note: Capacities and air flow rates refer to the version with AC motor, under conditions of 0 Pa available static pressure. For different available pressures, refer to the air flow variation diagrams.
(1) Inlet air temperature: 27°C d.b. / 19.5°C w.b.
Water inlet/outlet temperature: 7°C / 12°C
(2) Inlet air temperature: 20°C d.b.
Water inlet/outlet temperature: 45°C / 40°C
(3) Inlet air temperature: 20°C d.b.
Water inlet/outlet temperature: 70°C / 60°C
(4) Rated values measured with plenum chamber in accordance with AMCA 210-74 and duct plus

orifice plate in accordance with CNR-UNI 10023 standards.
(5) In free field, distance 3 m. Values calculated from sound power measured in a reverberation room in accordance with standards ISO 3740 - ISO 3742.
(1)(2)(3)(4)(5) Nominal technical data referring to air flow rate (4) at maximum speed and unit with free discharge
(*) Maximum speed
DN = Nominal diameter; F = Female gas connections

Dimensional Drawings

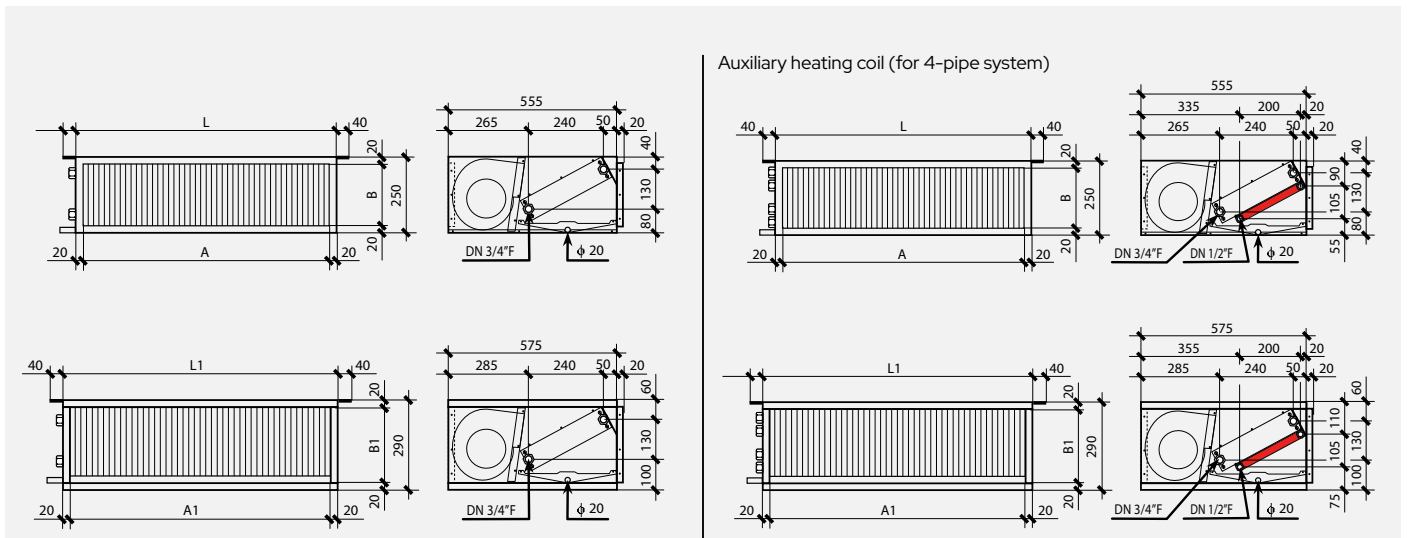

HCN "S" Version										
	60	75	86	103	130	150	136	170	200	
L	800	800	800	1.200	1.200	1.200	1.600	1.600	1.600	
A	760	760	760	1.160	1.160	1.160	1.560	1.560	1.560	
B	210	210	210	210	210	210	210	210	210	
Kg	34	35	37	48	50	53	63	65	68	

HCN Version "D"										
	60	75	86	103	130	150	136	170	200	
L1	840	840	840	1.240	1.240	1.240	1.640	1.640	1.640	
A1	800	800	800	1.200	1.200	1.200	1.600	1.600	1.600	
B1	250	250	250	250	250	250	250	250	250	
Kg	48	49	51	66	68	71	85	87	90	

HCN "S" Version - Hot Coil						
	60	75	103	130	136	170
L	800	800	1.200	1.200	1.600	1.600
A	760	760	1.160	1.160	1.560	1.560
B	210	210	210	210	210	210
Kg	36	37	51	53	67	69

HCN "D" Version - Hot Coil						
	60	75	103	130	136	170
L1	840	840	1.240	1.240	1.640	1.640
A1	800	800	1.200	1.200	1.600	1.600
B1	250	250	250	250	250	250
Kg	50	51	69	71	89	91

Dimensions in mm

Price list

HCN		60	75	86	103	130	136	150	170	200	
S-OIP	Single horizontal recessed panel with rear return air intake + Mamut terminal block	£	881	970	1.047	1.230	1.378	1.767	1.524	1.965	2.220
D-OIP	Double recessed horizontal panel with rear return + Mamut terminal block	£	1.104	1.194	1.272	1.613	1.706	2.105	1.807	2.304	2.558
S-OII	Single horizontal recessed panel with bottom return + Mamut terminal block	£	933	1.023	1.100	1.353	1.487	1.844	1.588	2.042	2.297
D-OII	Double panel, horizontal recessed unit with bottom return air + Mamut terminal block	£	1.157	1.246	1.324	1.677	1.871	2.379	2.181	2.635	2.885
WEEE		£	0,5	0,5	0,5	0,5	0,5	0,5	0,5	0,5	0,5
FACTORY-MOUNTED ACCESSORIES											
2V-2.5	No. 1 two-way valve for 2-pipe system with 230 V actuator	£	195	195	195	--	--	--	--	--	--
2V-4	No. 1 two-way valve for 2-pipe system with 230 V actuator	£	--	--	--	303	303	--	303	--	--
2V-6	No. 1 two-way valve for 2-pipe system with 230 V actuator	£	--	--	--	--	--	306	--	306	306
3V-2.5	No. 1 three-way valve for 2-pipe system with 230 V actuator	£	233	233	233	--	--	--	--	--	--
3V-4	No. 1 three-way valve for 2-pipe system with 230 V actuator	£	--	--	--	342	342	--	342	--	--
3V-6	No. 1 three-way valve for 2-pipe system with 230 V actuator	£	--	--	--	--	--	348	--	348	348
3VC-2,5	No. 1 three-way valve for heating coil (4-pipe system) with 230 V actuator	£	186	186	186	--	--	--	--	--	--
3VC-4	No. 1 three-way valve for heating coil (4-pipe system) with 230 V actuator	£	--	--	--	295	295	--	295	--	--
3VC-6	No. 1 three-way valve for heating coil (4-pipe system) with 230 V actuator	£	--	--	--	--	--	301	--	301	292
BC	Hot coil	£	226	227	--	389	286	381	--	379	--
TMB	Minimum hot water temperature thermostat (WEEE £0.02)	£	41	41	41	41	41	41	41	41	41
SFA-S	Removable flat air filter (non-ductable) EU3, made of simple galvanized sheet metal.	£	29	29	29	38	38	45	38	45	45
SFA-D	Removable flat air filter (non-ductable) EU3 in double pre-painted panel	£	31	31	31	40	40	48	40	48	48
SFC-S	Ductable EU3 air filter section + flat air filter in plain galvanized sheet metal	£	68	68	68	90	90	115	90	115	115
SFC-D	Ductable EU3 filter section + double-deck precoated sheet air filter	£	87	87	87	115	115	150	115	150	150
MB	Brushless motor with continuous 0-100% air flow modulation (0-10 Vdc control signal).	£	456	456	456	737	737	737	737	737	737

HCN		60	75	86	103	130	136	150	170	200	
ACCESSORIES SUPPLIED SEPARATELY											
CRA	230V wall thermostat (WEEE £0.02)	£	102	102	102	102	102	102	102	102	
MS	"230 Vac on/off" servomotor for air damper	£	662	662	662	662	662	662	662	662	
PMP	Condensate pump equipped with 8A (250V) alarm contact	£	331	331	331	331	331	331	331	331	
S2S-D	Closed section + 2 balancing/regulating dampers double pre-painted panel	£	850	850	850	1.075	1.075	1.302	1.075	1.302	
S2S-S	Closed section + 2 balancing/adjustment dampers (1 lower + 1 rear), simple galvanized sheet metal	£	714	714	714	901	901	1.091	901	1.091	
SBC-O	Auxiliary condensate drip tray + thermal insulation	£	32	32	32	32	32	32	32	32	
SCM-D	Double galvanized sheet metal section	£	326	326	326	452	452	544	452	544	
SCM-S	Sheet metal section with circular connections, plain galvanized sheet steel	£	214	214	214	317	317	383	317	383	
SDI.2X10A	Board with 2 outputs rated at 10A	£	261	261	261	261	261	261	261	261	
SDI.4X3A	Board with 4 outputs rated at 3A	£	266	266	266	266	266	266	266	266	
SFD-S	Ductable EU5 air filter section + HIGH-EFFICIENCY corrugated air filter H = 100 mm, simple galvanized sheet metal construction	£	104	104	104	134	134	152	134	152	
SFD-D	EU5 ductable air filter section + corrugated air filter H=100 mm HIGH-EFFICIENCY double pre-painted panel	£	148	148	148	187	187	215	187	215	
SSL-D	Double labyrinth silencer section in pre-painted double-skin panel	£	501	501	501	643	643	788	643	788	
SSL-S	Single-labyrinth silencer section in galvanized sheet metal	£	306	306	306	398	398	488	398	488	
SSM-D	Mixed outdoor-indoor air section or vice versa double pre-painted panel	£	492	492	492	641	641	792	641	792	
SSM-S	Outdoor/indoor air mixing section, or vice versa, in plain galvanized sheet metal	£	328	328	328	432	432	523	432	523	
TEL	System for remote control management (WEEE £0.02)	code	0119960060290								
		£	311	311	311	311	311	311	311	311	311

For the remote controller price lists, refer to the pages at the beginning of the chapter.

HCNP

Enhanced low-profile/flat ductable units with asynchronous AC or brushless DC motor

6.8 kW–12 kW



- Self-supporting structure in galvanized sheet metal with thermal and acoustic insulation (S version) or double 20 mm sandwich panel with pre-painted external sheet metal in white RAL 9002 (D version); equipped with ceiling/wall mounting holes, compact dimensions and optimized overall footprint.
- Double-slope condensate collection tray.
- High-efficiency heat exchange coil with copper tubes and aluminum fins, standard connections on the right-hand side.
- In the HCNP series, the double-inlet centrifugal fans with large-diameter plastic impellers featuring forward-curved, airfoil blades, mounted on elastic supports and vibration dampers, are equipped with higher-power motors to ensure higher available static pressures.
- The unit is equipped with an IP20 "Mammut"-type terminal block mounted outside the unit.
- The ductable units of the HCNP series are supplied without an air filter. A wide range of filters is available in the accessories section.

Configurations

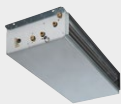

S-OIP

Single recessed horizontal panel with rear return air intake

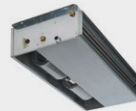

S-OII

Single recessed horizontal panel with bottom return



D-OIP

Double panel, horizontal recessed units with rear return air

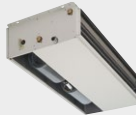

D-OII

Double panel, horizontal recessed units with bottom return

Versions

- **S-OIP**: Single concealed horizontal unit, rear return panel
- **D-OIP**: Double panel, horizontal recessed units with rear return air intake
- **S-OII**: Single recessed horizontal panel with bottom return
- **D-OII**: Double panel, horizontal recessed units with bottom return air

Standard with connection on the left. When ordering, it is possible to request connections on the right side.

Nomenclature

When ordering, always specify the full model as shown in the example below.

HCNP	-	S	-	OIP	-	120	-	DX
Series		Load-bearing casing		Version		Size		Connections
HCNP		S; D		OIP-OII		60.....120		DX; SX



HCNP-S-OIP 120-DX

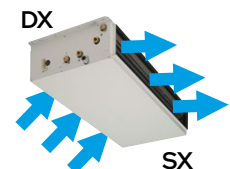

HCN, HCNP accessories

Factory-installed



TEL

System for remote control management. Main board + Air sensor + Water sensor + IR receiver + Remote control (management of 2/4-pipe systems, with/without valves). Fan: 7A-230Vac. Valves: 2A-230Vac.



BC

Auxiliary heating coil (for 4-pipe system)



MOR TMB

"Mammut"-type terminal block + minimum hot water temperature thermostat. Tset 32°C. All HCN units are supplied complete with a standard "Mammut"-type terminal block, without thermostat.



SFA-S SFA-D

Removable flat air filter (non-ductable) EU3 (S = single galvanized sheet metal, D = double pre-painted panel)



SND W4

Water temperature probe (NTC type 4700 Ohm@25°C) with adjustable minimum setpoint, 1 m cable length. Alternative to TMB thermostat.



SFC-S SFC-D

EU3 ductable air filter section + flat air filter (S = single galvanized sheet metal, D = double pre-painted panel)



MB

Brushless motor with continuous 0-100% air flow modulation (0-10 Vdc control signal).



3VC-2,5 3VC-4 3VC-6

No. 1 three-way valve for heating coil (4-pipe system) with 230 V actuator



3V-2,5 3V-4 3V-6

No. 1 three-way valve for 2-pipe system with 230 V actuator



2VC-2,5 2VC-4 2VC-6

No. 1 two-way valve for heating coil (4-pipe system) with 230V actuator



2V-2,5 2V-4 2V-6

No. 1 two-way valve for 2-pipe system with 230 V actuator

Ductable EU5 air filter section + corrugated HIGH-EFFICIENCY air filter H=100 mm (S=single galvanized sheet metal, D=double pre-painted panel)

Air pressure drop (clean/dirty filter)



SFD-S SFD-D

HCN	60	75	86	103	130	150	136	170	200
SFA (Pa)	15/35	17/42	16/38	23/55	27/66	25/60	22/54	28/66	25/60
SFC (Pa)	15/35	17/42	16/38	23/55	27/66	25/60	22/54	28/66	25/60
SFD (Pa)	20/37	24/44	22/41	32/59	38/70	35/64	31/58	39/71	35/64

Note: each individual kit includes only one valve with actuator. In the case of a 4-pipe system, 2 valves are required. Example: with a 4-pipe ducted unit, in the case of 3-way valves, 230 V power supply: 3V + 3VC.

Features of 3-way / 2-way valves - RECOMMENDED COMBINATIONS

HCN	60	75	86	103	130	150	136	170	200
Characteristic valve	Kvs 2,5			Kvs 4			Kvs 6		
User-side connections	DN 3/4" M								
Nominal pressure	PN 16 bar								

HCN, HCNP accessories

Provided separately



PMP

Condensate pump equipped with 8A (250V) alarm contact



MS

"230 Vac on/off" servomotor for air damper



SDI.4X3A

Board with 4 outputs at 3A (suitable for controlling up to 4 three-speed motors at 3A; e.g. 4 small fan coils).

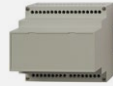

SDI.2X10A

Board with 2 x 10A outputs (suitable for controlling up to 2 three-speed 10A motors; e.g. 1 large unit with 2 motors).



**S2S-S
S2S-D**

Closed section + 2 balancing/adjustment dampers (1 lower + 1 rear) – dampers without actuators, prepared for manual control or motorization (S = single galvanized steel sheet, D = double pre-painted panel)



**SSL-S
SSL-D**

Labyrinth silencer section (for air intake and/or supply) (S=single galvanized sheet metal, D=double pre-painted panel)

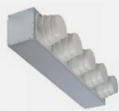

**Scm-S
Scm-D**

Sheet metal section with circular connections, variable "Ø", made of plastic material (S=single galvanized sheet metal, D=double pre-painted panel)

HCN	No. and Ø of circular connections								
	60	75	86	103	130	150	136	170	200
SCM no. x Ø	3xØ200/180/160			5xØ200/180/160			6xØ200/180/160		



**SSM-S
SSM-D**

Outdoor air (0–33%) / return air (100–67%) mixing section, or vice versa (interlocked dampers with manual controls, prepared for motorization) (S=single galvanized sheet metal, D=double pre-painted panel)

HCN	Air pressure drops								
	60	75	86	103	130	150	136	170	200
SSM (Pa)	13	15	14	20	24	22	20	24	22
S2S (Pa)	15	17	16	23	27	25	22	28	25



SBC-O

Auxiliary galvanized steel condensate collection tray with thermal insulation

			68	86	101	120	
HCNP	Cooling capacity (1) (*)	W	6.820	8.650	10.100	12.000	
	Sensible capacity (1) (*)	W	5.300	6.580	7.380	9.780	
	Thermal output (2) (*)	W	7.600	9.450	10.000	14.200	
	Thermal output (3) (*)	W	15.200	18.900	20.000	28.400	
	Air flow rate (4)	m³/h	1.350	1.500	1.450	2.750	
	Sound pressure Min-Mid-Max (7)	dB(A)	34-43-49	35-44-50	35-44-50	37-48-51	
	Nominal electrical power input	W	270	270	270	570	
	Rated current	A	1,25	1,25	1,25	2,70	
	No. of motors / no. of fans		1/1	1/1	1/1	1/2	
	Maximum available static pressure	Pa	184	194	194	182	
	Combined heating/cooling coil						
	No. of rows	no.	3	3	4	3	
	Hydraulic connection	∅	3/4" F	3/4" F	3/4" F	3/4" F	
	Water content	L	1,95	1,95	2,60	2,86	
	Heating and cooling outputs in 4-pipe configuration (HCNP + BC)						
	Cooling capacity (1) (*)	W	6.570	8.280	11.500	14.600	
	Sensible capacity (1) (*)	W	5.070	6.250	9.330	11.500	
	Heating capacity (3)	W	12.100	12.900	22.300	23.600	
Air flow rate (4)	m³/h	1.270	1.400	2.570	2.800		
Maximum available static pressure	Pa	186	196	184	192		

Note: Capacities and air flow rates refer to the version with AC motor, under conditions of 0 Pa available static pressure. For different available pressures, refer to the air flow variation diagrams.

(1) Inlet air temperature: 27°C d.b. / 19.5°C w.b.

Water inlet/outlet temperature: 7°C / 12°C

(2) Inlet air temperature: 20°C d.b.

Water inlet/outlet temperature: 45°C / 40°C

(3) Inlet air temperature: 20°C d.b.

Water inlet/outlet temperature: 70°C / 60°C

(4) Rated values measured with plenum chamber in accordance with AMCA 210-74 and duct plus orifice plate in accordance with CNR-UNI 10023 standards.

(7) In free field, distance 3 m. Values calculated from sound power measured in a reverberation chamber in accordance with ISO 3740 - ISO 3742.

(1)(2)(3)(4)(5)(6) Nominal technical data referring to air flow rate (4) at maximum speed and unit with free discharge

(*) Maximum speed

DN = Nominal diameter; F = Female gas connections

Dimensional Drawings

Auxiliary heating coil (for 4-pipe system)

HCNP "S" Version				
	68	86	101	120
L	800	800	800	1.200
A	760	760	760	1.160
B	235	235	235	235

HCNP "S" Version - Hot Coil				
	68	86	101	120
L	800	800	800	1.200
A	760	760	760	1.160
B	235	235	235	235

HCNP "D" Version				
	68	86	101	120
L1	840	840	840	1.240
A1	800	800	800	1.200
B1	275	275	275	275

HCNP "D" Version - Hot Coil				
	68	86	101	120
L1	840	840	840	1.240
A1	800	800	800	1.200
B1	275	275	275	275

Dimensions in mm

Price list

HCNP			68	86	101	120
S-OIP	Single recessed horizontal panel with rear return + Mamut terminal block	£	1.094	1.188	1.268	1.595
D-OIP	Double recessed horizontal panel with rear return + Mamut terminal block	£	1.352	1.445	1.526	1.921
S-OII	Single horizontal recessed panel with bottom return + Mamut terminal block	£	1.153	1.248	1.329	1.669
D-OII	Double panel, horizontal recessed unit with bottom return air + Mamut terminal block	£	1.412	1.506	1.587	1.993
FACTORY-MOUNTED ACCESSORIES						
2V-2.5	No. 1 two-way valve for 2-pipe system with 230 V actuator	£	195	195	-	-
2V-4	No. 1 two-way valve for 2-pipe system with 230 V actuator	£	-	-	303	303
2V-6	No. 1 two-way valve for 2-pipe system with 230 V actuator	£	-	-	-	-
3V-2.5	No. 1 three-way valve for 2-pipe system with 230 V actuator	£	233	233	-	-
3V-4	No. 1 three-way valve for 2-pipe system with 230 V actuator	£	-	-	342	342
3V-6	No. 1 three-way valve for 2-pipe system with 230 V actuator	£	-	-	-	-
3VC-2,5	No. 1 three-way valve for heating coil (4-pipe system) with 230 V actuator	£	186	186	-	-
3VC-4	No. 1 three-way valve for heating coil (4-pipe system) with 230 V actuator	£	-	-	296	296
3VC-6	No. 1 three-way valve for heating coil (4-pipe system) with 230 V actuator	£	-	-	-	-
BC	Hot coil	£	241	241	-	305
MB	Brushless motor with stepless 0–100% airflow modulation (0–10 Vdc signal)	£	011004250906011 294	011004250906011 294	011004250906011 294	011004250906012 497
TMB	Minimum hot water temperature thermostat	£	41	41	41	41
SFA-S	Removable flat air filter (non-ductable) EU3, made of simple galvanized sheet metal.	£	35	35	35	44
SFA-D	Removable flat air filter (non-ductable) EU3 in double pre-painted panel	£	38	38	38	48
SFC-S	Ductable EU3 air filter section + flat air filter in plain galvanized sheet metal	£	82	82	82	107
SFC-D	Ductable EU3 filter section + double-deck precoated sheet air filter	£	102	102	102	136
ACCESSORIES SUPPLIED SEPARATELY						
MS	"230 Vac on/off" servomotor for air damper	£	662	662	662	662
PMP	Condensate pump equipped with 8A (250V) alarm contact	£	408	408	408	408
S2S-D	Closed section + 2 balancing/regulation dampers double pre-painted panel	£	963	963	963	1.216
S2S-S	Closed section + 2 balancing/adjustment dampers (1 lower + 1 rear), simple galvanized sheet metal	£	806	806	806	1.019
SBC-O	Auxiliary condensate drip tray + thermal insulation	£	38	38	38	38
SCM-D	Double galvanized sheet metal section	£	372	372	372	516
SCM-S	Sheet metal section with circular connections, plain galvanized sheet steel	£	250	250	250	363
SDI.2X10A	Board with 2 outputs rated at 10A	£	261	261	261	261
SDI.4X3A	Board with 4 outputs rated at 3A	£	266	266	266	266
SFD-S	Ductable EU5 air filter section + HIGH-EFFICIENCY corrugated air filter H = 100 mm, simple galvanized sheet metal construction	£	123	123	123	152
SFD-D	EU5 ductable air filter section + corrugated air filter H=100 mm HIGH-EFFICIENCY double pre-painted panel	£	169	169	169	214
SSL-D	Double labyrinth silencer section in pre-painted double-skin panel	£	572	572	572	733
SSL-S	Single-labyrinth silencer section in galvanized sheet metal	£	348	348	348	453
SSM-D	Outdoor-indoor (or vice versa) air mixing section with double pre-painted panel	£	562	562	562	730
SSM-S	Outdoor/indoor air mixing section, or vice versa, in plain galvanized sheet metal	£	372	372	372	492
TEL	System for remote control management	code	0119960060290			
		£	311	311	311	311

For the remote controller price lists, refer to the pages at the beginning of the chapter.

HCNA

Medium ductable units with AC asynchronous or DC brushless motor

7 kW–68 kW

HCNA units are compact, freely configurable air handling units. You can choose from: 2 motor options (6-pole or brushless), 2 types of load-bearing casings (S or D), the 2-pipe/4-pipe version, and a wide range of compatible accessories.

The high flexibility, together with the wide output range, makes HCNA the winning solution that always allows you to find the right configuration for your specific needs.

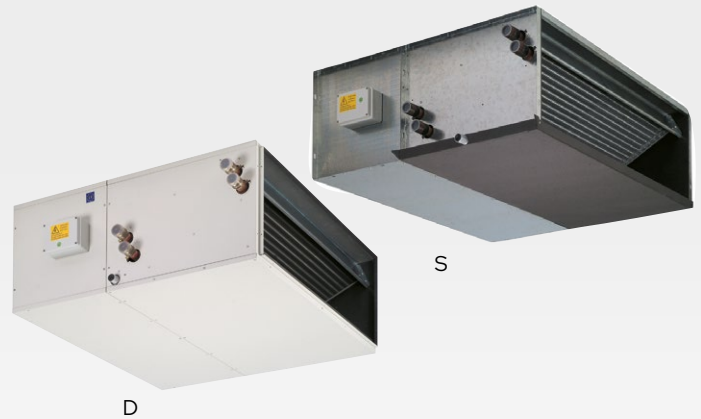

Construction Features

- Load-bearing structure in heavy-gauge galvanized sheet metal, resistant to rust, corrosion, chemicals, solvents, aliphatics, and alcohols.
- Self-supporting, removable panels; assembled with self-tapping screws for quick and easy inspection/maintenance. Load-bearing casings are available in "S" version (single panel) and "D" version (20 mm double sandwich panel with pre-painted outer sheet, white RAL 9002).
- The units are equipped with high-efficiency heat exchange coils (without air vent valves) made of copper tubes and aluminum fins.
- Standard connections on the right; on request and at an additional cost, connections on the left.
- The sections with cooling coil are equipped with a galvanized steel

condensate drain pan with external thermal insulation (on request, at extra cost, in AISI 304 stainless steel) with single slope to ensure optimal condensate drainage, complete with Ø30 mm drain connection.

- The standard electrical equipment includes: "Mammut"-type IP20 terminal blocks, with the terminal block mounted outside the unit on the same side as the hydraulic connections. For units with 2 motors, the installation of 3 relays or of the interface board is recommended.
- All standard versions are supplied with free intake and discharge openings, without any grille/guard and without an air filter.
- No. 2 motor drives: 6-pole or brushless

Versions

- S: Recessed version - Single panel
- D: Exposed version - Double panel

Standard with connection on the left. When ordering, it is possible to request connections on the right side.

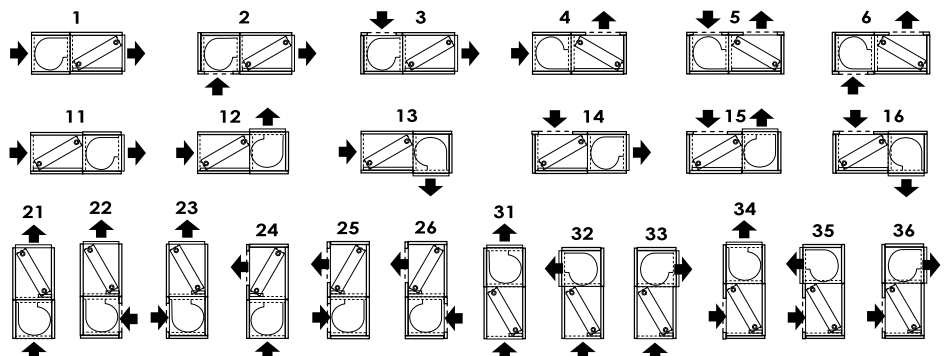

Accessories

Provided separately



MOR-TMB

"Mammut"-type terminal block + minimum hot water temperature thermostat. Tset 32°C. All HCN units are supplied complete with a standard "Mammut"-type terminal block, without thermostat.



PMP

Condensate pump with integrated 0.5 L tank, equipped with 4A (250V) alarm contact



SDI.4X3A

Board with 4 outputs at 3A (suitable for controlling up to 4 three-speed motors at 3A; e.g. 4 small fan coils).

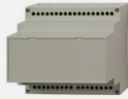

SDI.2X10A

Board with 2 x 10A outputs (suitable for controlling up to 2 three-speed 10A motors; e.g. 1 large unit with 2 motors).



**PFT-S
PFT-D**

Ductable air filter section + EU7 pocket air filter, H = 400 mm. VERY HIGH EFFICIENCY (S = single galvanized sheet metal, D = double pre-painted panel)



**P2S-S
P2S-D**

Closed section + 2 balancing/adjustment dampers (1 lower and 1 rear). Dampers without actuators, prepared for manual control or motorization. (S = single galvanized sheet metal, D = double pre-painted panel)



**PMA-S
PMA-D**

Outdoor air (0-33%) / return air (100-67%) mixing section (S=single galvanized sheet metal, D=double pre-painted panel)



MS

"230 Vac on/off" servomotor for air damper



**P90-S
P90-D**

90° Section (S = single galvanized sheet metal, D = double pre-painted panel)



**PCR-S
PCR-D**

Sheet metal section with circular "Ø" connections, internally insulated (S = single galvanized sheet metal, D = double pre-painted panel)



**PSL-S
PSL-D**

Labyrinth silencer section, suitable for both intake and supply air openings (S = single galvanized sheet metal, D = double pre-painted panel).

Coil characteristics

	HCNA	71	117	143	165	216	290	240	293	330	565	685
Coil hot/cold	Kvs characteristic	2,33	3,78	4,58	5,65	6,65	9,00	8,22	9,91	11,04	16,36	19,73
	User-side connections DN	3/4"M	1"M	1"M	1"M	1"-1/4M	1"-1/2M	1"-1/4M	1"-1/2M	1"-1/2M	1"-1/2M (4R)	1"-1/2M (4R)
Hot coil	Kvs characteristic	1,66	2,56	3,23	3,94	4,64	6,46	5,73	7,14	7,98	9,67	11,53
	User-side connections DN	3/4"M	1"M	1"M	1"M	1"-1/4M	1"-1/4M	1"-1/4M	1"-1/4M	1"-1/4M	1"-1/4M	1"-1/4M

Valve features

3-way valve		(1) Each individual kit includes only one control valve.											
3V / 3VM	DN 3/4" Kvs 2,8	DN 1" Kvs 5,2					DN 1 1/4" Kvs 13,0			DN 1 1/2" Kvs 16,0			
2-way valve		(1) Each individual kit includes only one control valve.											
2V / 2VM	DN 3/4" Kvs 2,8	DN 1" Kvs 5,2					DN 1 1/4" Kvs 13,0			DN 1 1/2" Kvs 16,0			

(1) Each individual valve kit is compatible with any size of HCNA unit.
For on-off valves, it is recommended to use valves with a high Kvs value – for modulating valves, it is recommended to use valves with a Kvs value comparable to the Kvs of the coil.

The heating coil of the HCNA units (4-pipe system) uses the same type of valves. Therefore, in a 4-pipe system, 2 valves (2 codes) must be provided.

Accessories

Factory-installed



BC

Auxiliary hot coil, 2 rows



PFA-S
PFA-D

Ductable air filter section + EU3 flat air filter (S = single galvanized sheet metal, D = double pre-painted panel)



TEL

System for remote control management. Main board + Air sensor + Water sensor + IR receiver + Remote control (management of 2/4-pipe systems, with/without valves). Fan: 7A-230Vac. Valves: 2A-230Vac.



PFO-S
PFO-D

Ductable air filter section + corrugated EU5 air filter, H = 100 mm, HIGH EFFICIENCY (S = single galvanized sheet metal, D = double pre-painted panel)



3V-2.8
3V-5.2
3V-13
3V-16

No. 1 three-way valve with 230V actuator



2V-2.8
2V-5.2
2V-13
2V-16

No. 1 two-way valve with 230V actuator



MB

Brushless motor with continuous 0-100% air flow modulation (0-10 Vdc control signal).

HCNA	HCNA		71	117	143	165	216⁽⁷⁾	290⁽⁷⁾	240⁽⁷⁾	293⁽⁷⁾	330⁽⁷⁾	565⁽⁷⁾	685⁽⁷⁾
	Cooling capacity (1)	kW	7,3	11,7	14,6	17,0	22,2	29,8	24,1	30,1	34,0	58,1	70,1
	Sensible output (1)	kW	5,9	9,8	12,0	14,0	18,3	24,3	20,2	24,6	28,1	44,5	55,4
	Thermal power (2)	kW	17,2	28,3	34,9	40,7	52,9	69,9	58,8	71,2	80,9	125,7	157,2
	Heating capacity (3)	W	8.350	14.100	17.000	19.700	25.650	34.100	29.300	34.600	39.150	60.950	76.650
	Airflow rate (3)	m³/h	1500	2500	3000	3500	5000	6000	5000	6000	7000	10000	12000
	Water flow rate (4)												
	Cooling	l/h	1256	2012	2511	2924	3818	5126	4145	5177	5848	9993	12057
	Heating	l/h	1479	2434	3001	3500	4549	6011	5057	6123	6957	10810	13519
	Water pressure drops (4)												
	Cooling	kPa	27,7	27,3	29,7	27,5	28,1	32,8	25,7	27,4	29,0	32,4	35,0
	Heating	kPa	30,0	31,1	33,1	30,7	31,0	35,2	30,1	30,0	32,0	29,6	34,3
	Sound pressure (5)												
	Min-Med-Max	dB(A)	35-41-46	42-48-54	40-45-54	43-47-53	48-52-58	47-51-57	45-51-57	43-48-57	46-50-56	51-55-61	50-54-60
	Motors/Fans	n°/n°	1/1	1/1	1/1	1/1	1/1	1/1	2/2	2/2	2/2	2/2	2/2
	Absorbed current	A	1x2,4	1x5,0	1x5,0	1x7,0	1x7,2	1x9	2x5	2x5	2x7	2x7,2	2x9
	Power supply		230Vac - 1 Ph - 50Hz										
Poles	no.	4											
Coil/Rows	no.	3R	3R	3R	3R	3R	3R	3R	3R	3R	3R	4R	4R
Hydraulic connections	Ø	3/4"M	1"M	1"M	1"M	1"1/4 M	1"1/4 M	1"1/4 M	1"1/4 M	1"1/4 M	1"1/4 M	1"1/4 M	
Condensate drain	Ø mm	30	30	30	30	30	30	30	30	30	30	30	
HCNA Hot Coil	HCNA		71	117	143	165	216⁽⁷⁾	290⁽⁷⁾	240⁽⁷⁾	293⁽⁷⁾	330⁽⁷⁾	565⁽⁷⁾	685⁽⁷⁾
	Thermal power (2)	W	13,3	21,7	27,3	31,7	40,4	54,5	44,8	55,3	62,4	85,2	103,1
	Water flow rate (5)												
	Heating	l/h	1144	1866	2348	2726	3474	4687	3853	4756	5366	7327	8867
	Water pressure drops (5)												
	Heating	kPa	35,1	36,3	37,7	38,6	40,4	37,3	37,7	34,7	37,1	37	40,2
	Coil/Rows	no.	2R	2R	2R	2R	2R	2R	2R	2R	2R	2R	2R
Hydraulic connections	Ø	3/4"M	1"M	1"M	1"M	1"1/4 M	1"1/4 M	1"1/4 M	1"1/4 M	1"1/4 M	1"1/4 M	1"1/4 M	

(1) Entering air temperature: 27°C d.b. / 19°C w.b. - Entering/leaving water temperature: 7°C / 12°C Maximum speed

(2) Inlet air temp.: 20°C d.b. - Inlet/outlet water temp.: 70°C / 60°C Max speed

(3) Entering air temp.: 20°C d.b. - Entering/leaving water temp.: 45°C / 40°C Max speed

(4) Rated values measured with plenum chamber in accordance with AMCA 210-74 and duct plus orifice plate in accordance with CNR-UNI 10023 standards.

(6) In free field, at a distance of 3 m. Values calculated from sound power measured in a

reverberation room in accordance with ISO 3740 - ISO 3742.

(7) With AIRMUST 3VA1 and CRA accessories. For units equipped with a motor with electrical absorption greater than 3A, or with 2 motors, add 1 SDI.2x10A interface board.

(1)(2)(3)(4)(5) Nominal technical data referring to air flow rate (4) at maximum speed and unit with free discharge

(*) DN = Nominal diameter; F = Female gas connections

Dimensional Drawings

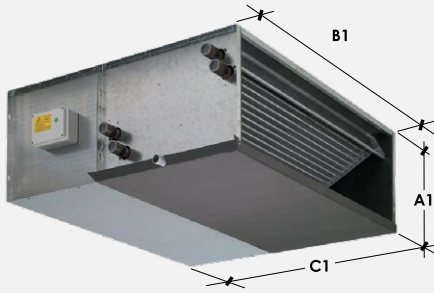

S: Recessed version – Single panel

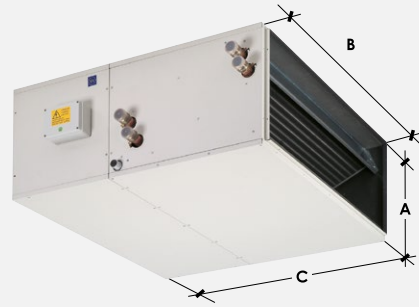

D: Exposed version – Double panel

HCNA "S" Version

	71	117	143	165	216	290	240	293	330	565	685
A1	360	425	425	480	550	550	425	425	480	580	580
B1	560	660	760	760	1.160	1.360	1.160	1.360	1.360	1.660	1.660
C1	840	995	1.105	1.160	1.140	1.240	995	1.105	1.160	1.450	1.450
Kg	35,8	46,6	55,7	60,6	93,7	107,8	78,5	94,8	103,5	179,1	181,1

HCNA "D" Version

	71	117	143	165	216	290	240	293	330	565	685
A	380	440	440	480	570	570	440	440	480	600	600
B	520	620	720	720	1.120	1.320	1.120	1.320	1.320	1.620	1.620
C	870	1.020	1.120	1.160	1.150	1.250	1.020	1.120	1.160	1.470	1.470
Kg	45,1	59,5	71,3	77,3	118,9	138,7	99,7	121,4	131,4	224,4	226,4

HCNA "S" Version - with hot coil

	71	117	143	165	216	290	240	293	330	565	685
A1	360	425	425	480	550	550	425	425	480	580	580
B1	560	660	760	760	1.160	1.360	1.160	1.360	1.360	1.660	1.660
C1	840	995	1.105	1.160	1.140	1.240	995	1.105	1.160	1.450	1.450
Kg	40,2	52,1	62,3	67,2	104,7	123,8	89,5	110,8	119,5	203,1	205,1

HCNA Version "D" - with hot coil

	71	117	143	165	216	290	240	293	330	565	685
A	380	440	440	480	570	570	440	440	480	600	600
B	520	620	720	720	1.120	1.320	1.120	1.320	1.320	1.620	1.620
C	870	1.020	1.120	1.160	1.150	1.250	1.020	1.120	1.160	1.470	1.470
Kg	49,5	65,0	77,9	83,9	129,9	154,7	110,7	137,4	197,4	248,4	250,4

Dimensions in mm

***WARNING:** Check that the electrical current draw of the unit motors is compatible with the contact rating of the remote controls. If the electrical current draw is higher, or if the unit is equipped with two motors, it is recommended to use the SDI interface board.

- (1) All HCNA units are supplied complete with standard "Mammut"-type terminal block, without thermostat.
- (2) Each control panel can control only one unit (see "SDI" accessory).

Price list

HCNA			71	117	143	165	216 (1)	240 (1)(2)	290 (1)	293 (1)(2)	330 (1)(2)	565 (1)(2)	685 (1)(2)
S	Recessed version - Single panel + Mammoth-type terminal board	£	1.522	1.908	2.255	2.556	3.113	3.812	3.323	4.002	4.581	6.669	6.868
D	Exposed version - Double panel + Mammoth-type terminal board	£	2.099	2.631	3.068	3.415	4.283	5.138	4.320	5.145	5.779	8.299	8.499
FACTORY-MOUNTED ACCESSORIES													
2V-13	No. 1 two-way valve with 230V actuator	£	942										
2V-16	No. 1 two-way valve with 230V actuator	£	1.044										
2V-2.8	No. 1 two-way valve with 230V actuator	£	180										
2V-5.2	No. 1 two-way valve with 230V actuator	£	211										
3V-13	No. 1 three-way valve with 230V actuator	£	1.089										
3V-16	No. 1 three-way valve with 230V actuator	£	1.223										
3V-2.8	No. 1 three-way valve with 230V actuator	£	255										
3V-5.2	No. 1 three-way valve with 230V actuator	£	293										
BC	Hot coil	£	374	531	678	678	915	915	1.166	1.166	1.166	1.802	1.802
TMB	Minimum hot water temperature thermostat	£	41										
PFA-D	Ductable air filter section + EU3 flat air filter Double pre-painted panel	£	302	367	406	429	641	545	720	613	650	865	870
PFA-S	Ductable air filter section + flat EU3 air filter, simple galvanized sheet metal Single pre-painted panel	£	133	163	184	196	304	253	345	286	308	422	427
PFO-D	Ductable air filter section + corrugated EU5 air filter, H=100 mm, high efficiency Double pre-painted panel	£	333	413	459	488	748	629	849	711	760	1.029	1.033
PFO-S	Ductable air filter section + corrugated EU5 air filter, H=100 mm, high efficiency Plain galvanized sheet steel	£	162	210	236	255	411	334	475	383	419	586	592
MB	Brushless motor	£	1.365	1.258	1.208	910	1.582	2.117	2.515	2.414	1.818	3.165	4.233
ACCESSORIES SUPPLIED SEPARATELY													
MS	"230 Vac on/off" servomotor for air damper	£	662	662	662	662	852	662	852	662	662	852	852
P2S-D	Closed section + 2 balancing/adjustment dampers (1 lower and 1 rear). Double pre-painted panel.	£	813	934	1.008	1.117	1.611	1.279	1.767	1.412	1.558	2.044	2.049
P2S-S	Closed section + 2 balancing/adjustment dampers (1 lower and 1 rear). Simple galvanized sheet metal.	£	570	633	681	765	1.092	857	1.198	947	1.061	1.376	1.381
P90-S	90° section. Simple galvanized sheet metal	£	138	171	187	200	295	240	324	263	281	382	387
P90-D	90° section. Double pre-painted panel	£	376	470	508	548	805	650	885	718	771	1.039	1.045
PCR-D	Sheet metal section with circular "Ø" connections, internally insulated. Double pre-painted panel	£	560	677	726	765	1.130	976	1.315	1.149	1.199	1.512	1.518
PCR-S	Sheet metal section with circular "Ø" connections, internally insulated. Plain galvanized sheet metal.	£	322	379	402	415	619	561	755	694	715	853	862
PFT-D	Ductable air filter section + EU7 pocket air filter, H=400 mm, ultra-high efficiency. Double pre-painted panel	£	525	634	695	734	1.087	933	1.221	1.051	1.112	1.463	1.469
PFT-S	Ductable air filter section + EU7 pocket air filter, H = 400 mm, very high efficiency. Plain galvanized sheet metal.	£	253	317	355	382	602	499	689	573	618	850	855
PMA-S	Outdoor air mixing section (0-33%) / return air (100-67%). Plain galvanized sheet metal	£	202	243	261	286	414	333	454	366	399	531	536
PMA-D	Outdoor air (0-33%) / return air (100-67%) mixing section. Double pre-painted panel	£	441	540	584	634	927	744	1.014	821	886	1.189	1.194
PMP	Condensate pump with integrated 0.5 L tank, equipped with 4A (250V) alarm contact	£	401	401	401	401	401	401	401	401	401	401	401
PSL-D	Labyrinth silencer section, suitable for both air intake and supply openings. Double pre-painted panel	£	527	654	707	764	1.124	904	1.232	996	1.072	1.447	1.459
PSL-S	Labyrinth silencer section, suitable for both intake and supply air openings. Plain galvanized sheet metal.	£	291	357	385	415	610	492	671	543	584	788	797
SDI.2X10A (1)(2)	Board with 2 outputs (2 motors, 3 speeds) rated at 10 A	£	261	261	261	261	261	261	261	261	261	261	261
SDI.4X3A	Board with 4 outputs (4 motors, 3 speeds) rated at 3 A	£	266	266	266	266	266	266	266	266	266	266	266
TEL (2)	System for remote control management	£	311	311	311	311	311	311	311	311	311	311	311

(1) With AIRMUST 3VA1, AIRMUST P and CRA accessories, when combined with units with an electrical absorption greater than 3A, or with 2 motors, please add the SDI.2x10A interface board.

(2) With the TEL accessory, if combined with a unit having an electrical absorption greater than 7A, or with 2 electric motors, please add the SDI.2x10A interface board.

For the wired controller price lists, refer to the pages at the beginning of the chapter.



01271 850 204 | energylabuk.com
sales@energylabuk.com | @the-energy-lab-solutions



April 2026

Registered Address: Millennium House, Brannam Crescent, Roundswell Business Park, Barnstaple, Devon, EX31 3TD United Kingdom | Company Number: 08586990



www.maxa.it



All the information and scripts contained in this catalogue are exclusive property of ADVANTIX SPA. ADVANTIX SPA might have patterns, brands, copyrights or other rights of intellectual property in being or outstanding and covering certain subjects or belonging to some products shown in this catalogue. The possession of this catalogue does not imply the right to use these patterns, brands, copyright or other intellectual properties unless it is allowed by ADVANTIX SPA with a written agreement. ADVANTIX SPA does not assume responsibility for any errors or imprecision in the content of this catalog and reserves the right to make changes to its products any time without notice, according for technical or commercial market needs.